

manduca[®]

my baby carrier /
mon porte-bébé

xt

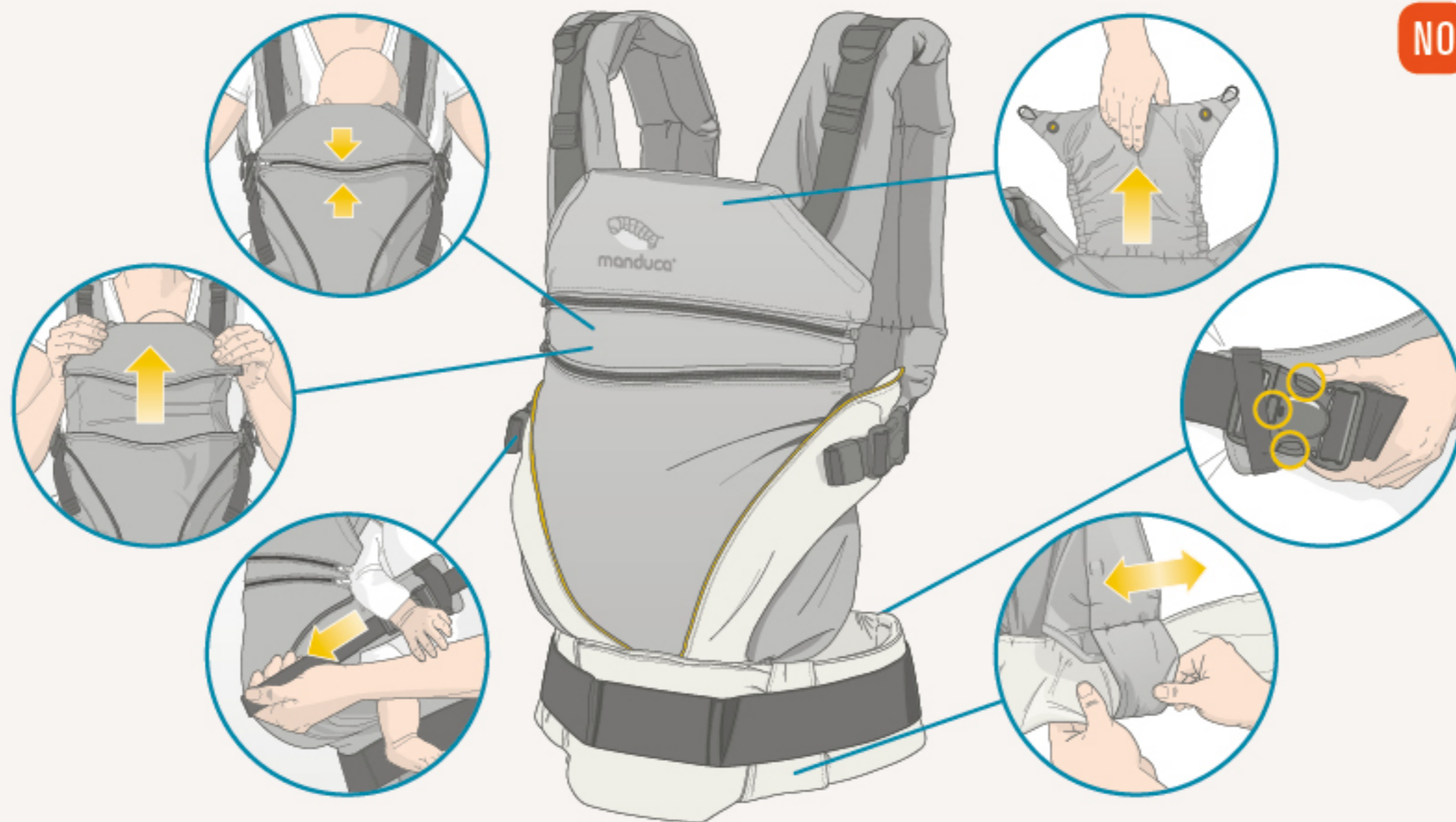

NO Bruksanvisning

VIKTIG! TA VARE PÅ BRUKSANVISNINGEN TIL SENERE BRUK

Les nøye gjennom denne anvisningen før første gangs bruk!

OBS

OBS Følg med på barnet ditt og pass på at munn og nese ikke tildekkes.

OBS For premature babyer, babyer med lav fødselsvekt og barn med medisinske problemer må du snakke med lege/jordmor før du bruker produktet.

OBS Pass på at haken til barnet ditt ikke ligger inntil barnets bryst. Dette kan hindre det i å puste, og det kan kveles.

OBS For å unngå fare for at babyen kan falle ut, må du plassere babyen din sikkert i bæresjalet.

Vær forsiktig ved aktiviteter som matlaging eller rengjøring, i nærheten av varmekilder eller varme drikker.

Bæresjalet skal alltid bare brukes til ett barn.

Bæresjalet er laget utelukkende for å bære barnet i en posisjon der det er vendt mot deg.

Du kan miste balansen som følge av dine og barnets bevegelser.

Vær forsiktig når barnet lener seg framover eller til siden.

Ikke bruk bæreselen når du driver sport som f.eks. jogging, sykling, svømming eller alpint.

Vær oppmerksom på at faren for å falle ut øker så snart barnet ditt blir mer aktivt og mobilt.

OPPBEVARING OG VEDLIKEHOLD

Sørg for at bæreselen ikke er tilgjengelig for barn når den ikke er i bruk.

Sjekk bæreselen jevnlig for tegn til slitasje som revne sømmer og riss i stoffet.

Lukk alle spenner før vask og for oppbevaring.



Finvaskemiddel

manduca[®]

my baby carrier /
mon porte-bébé

xt



4

Hodestøtte



6

Første skritt



10

Bæring på magen



18

Bæring på hoften



22

Ryggbæring

Hodestøtte

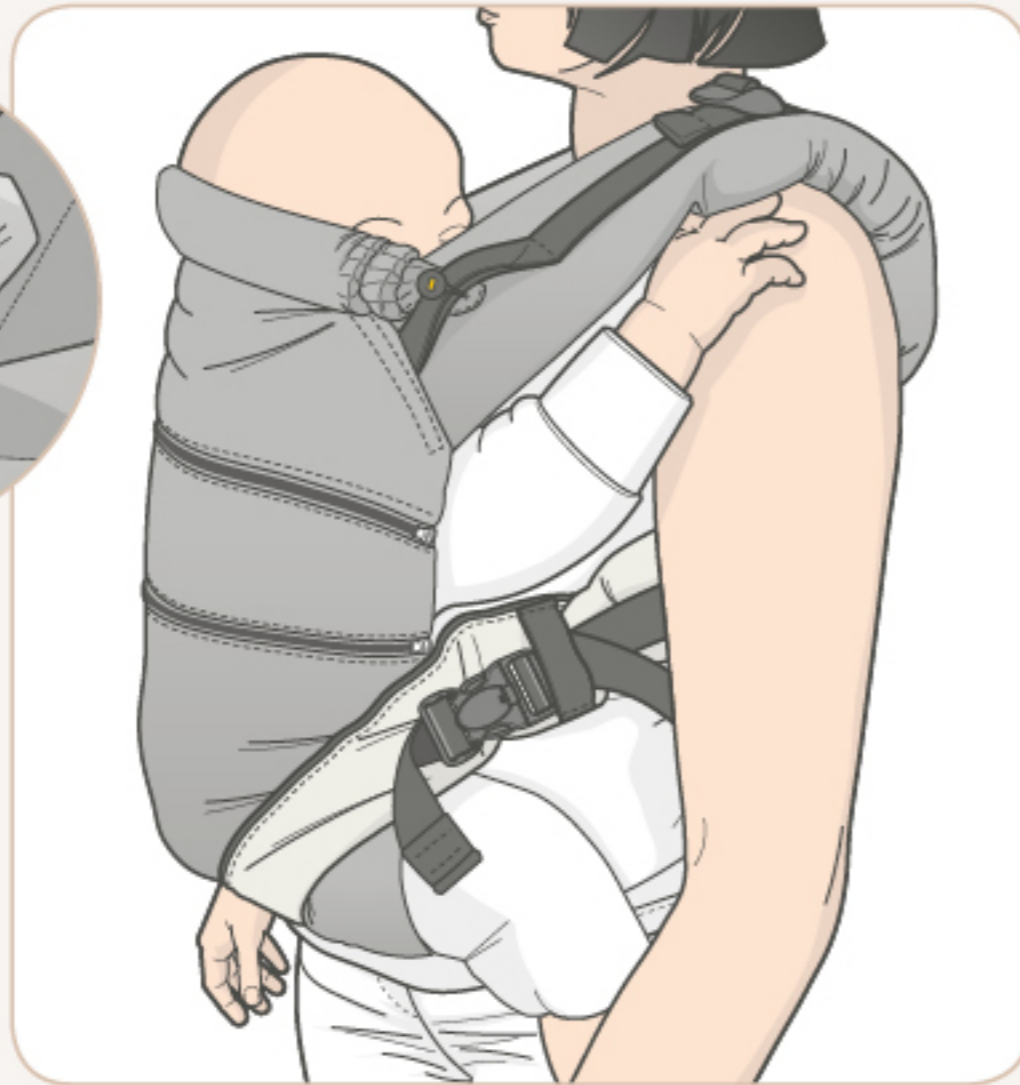
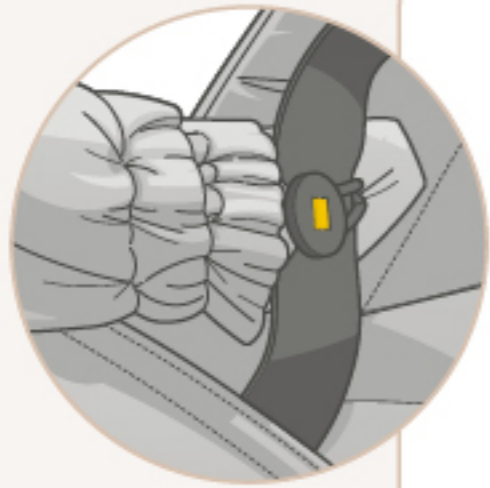

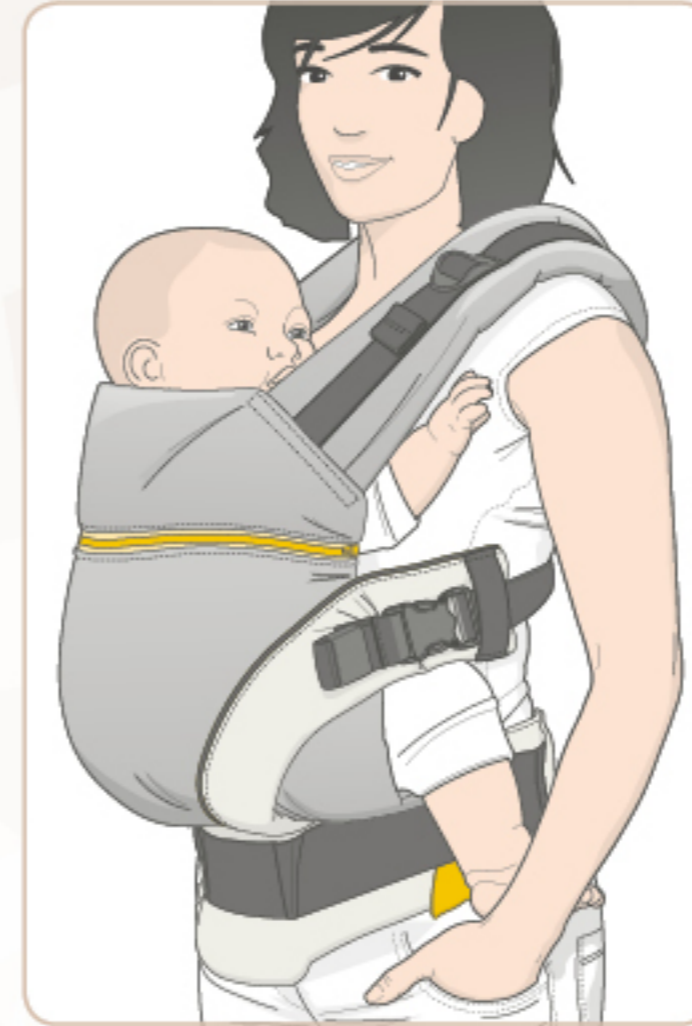



Første skritt

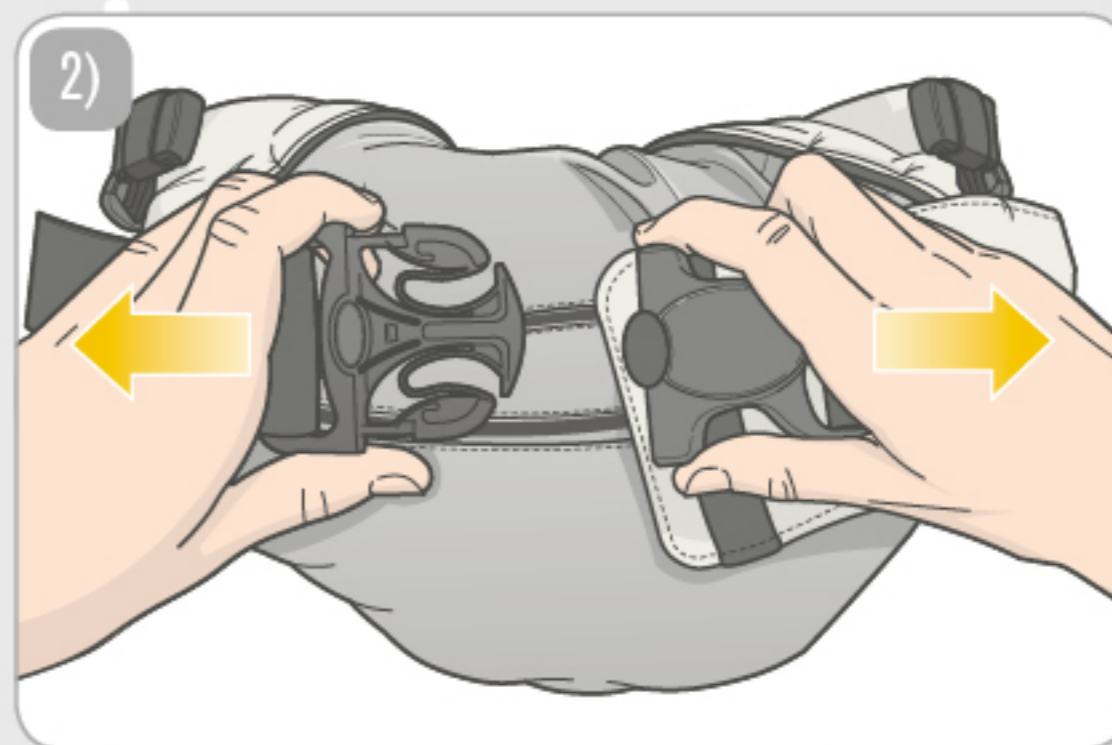
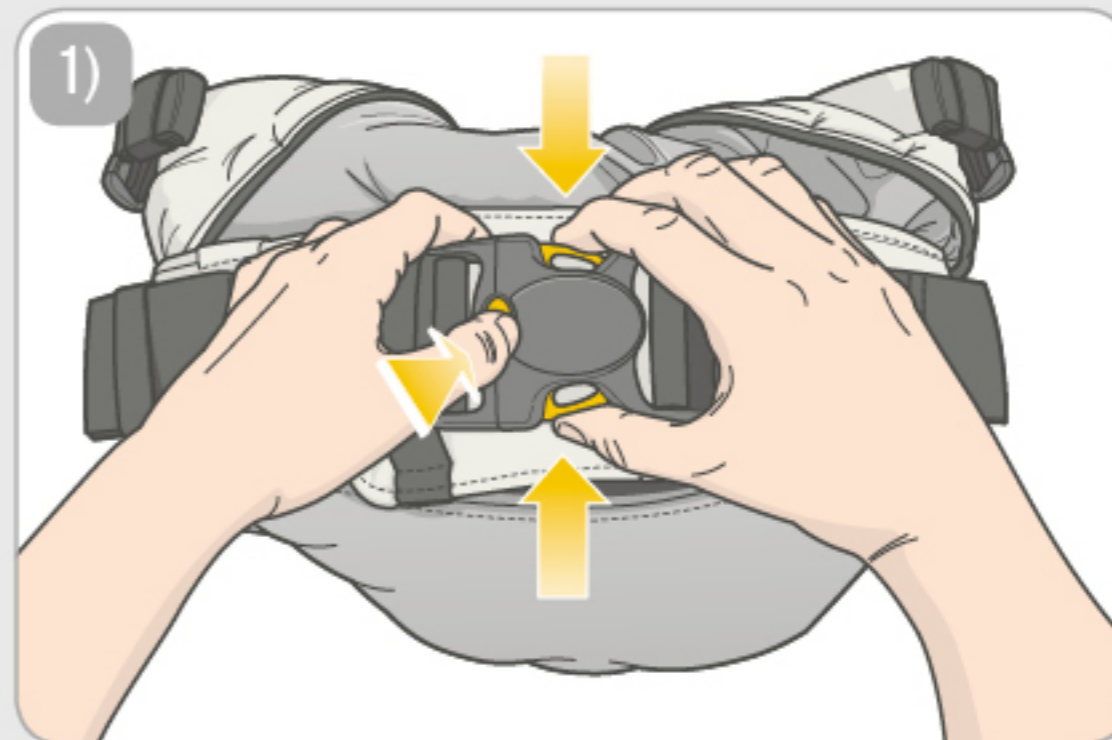
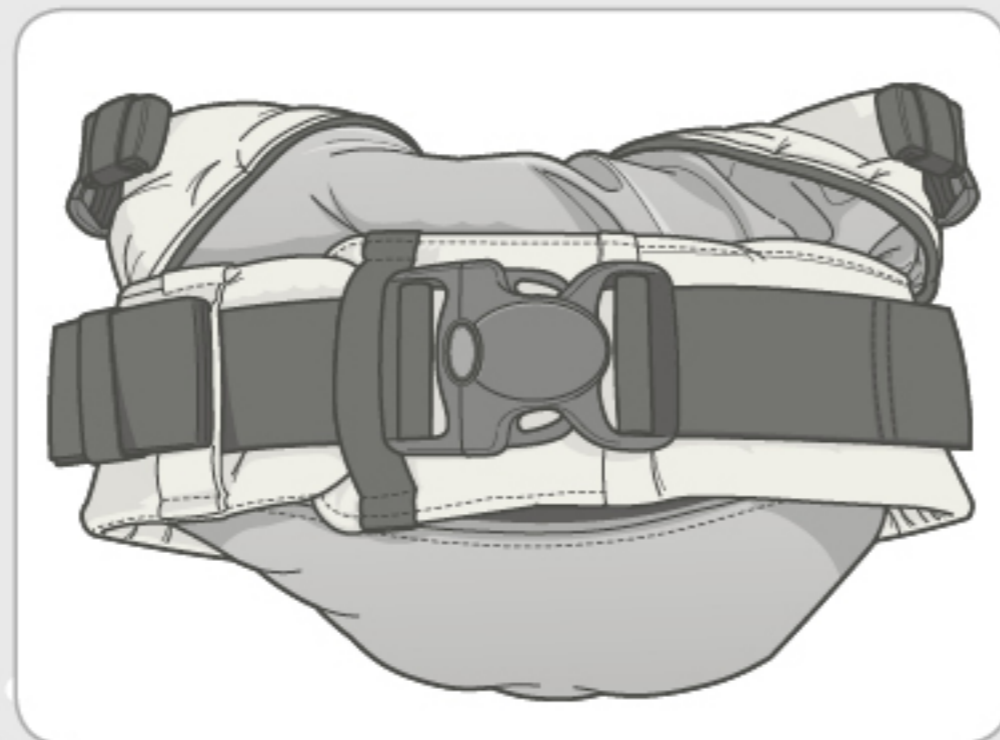

3)

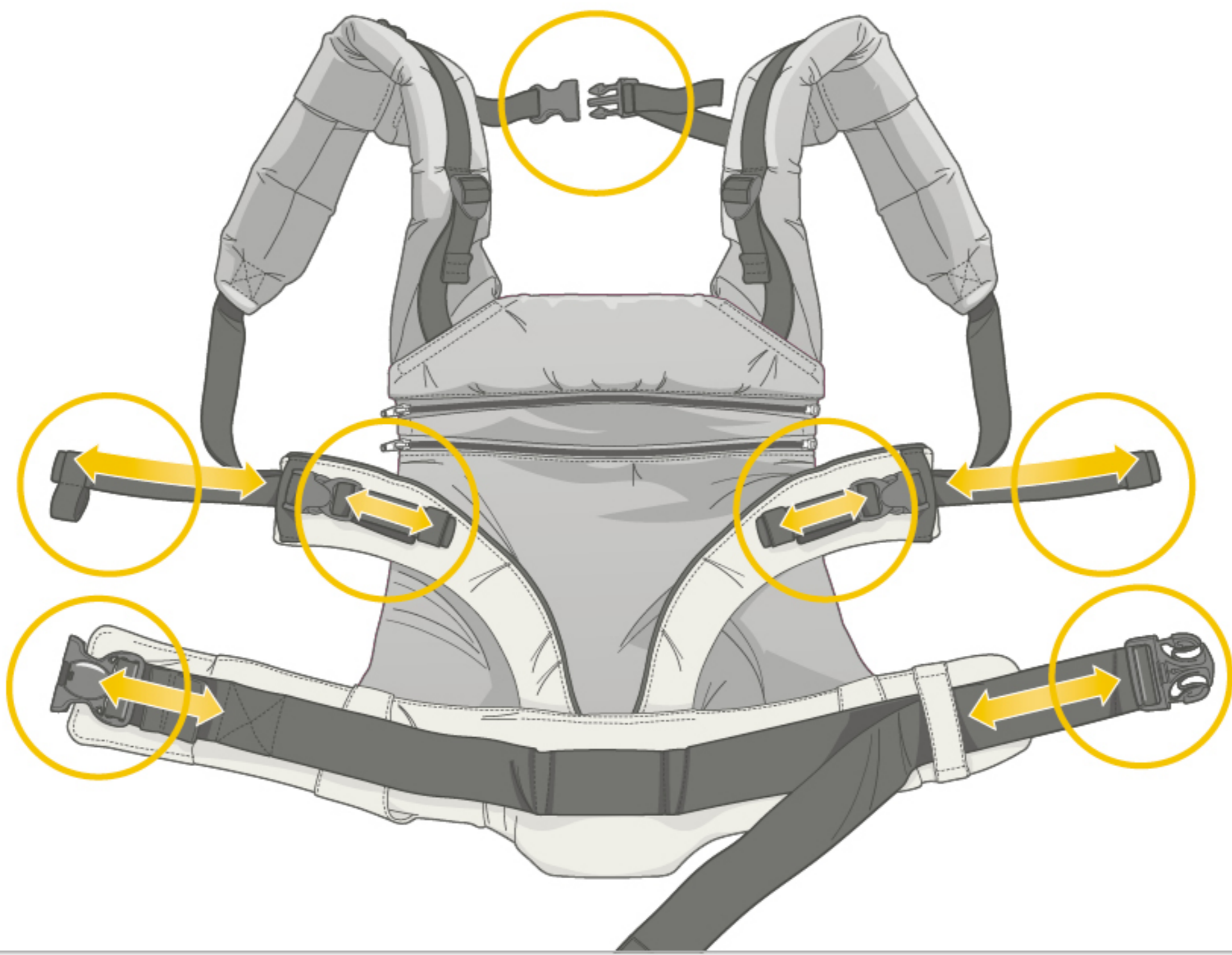

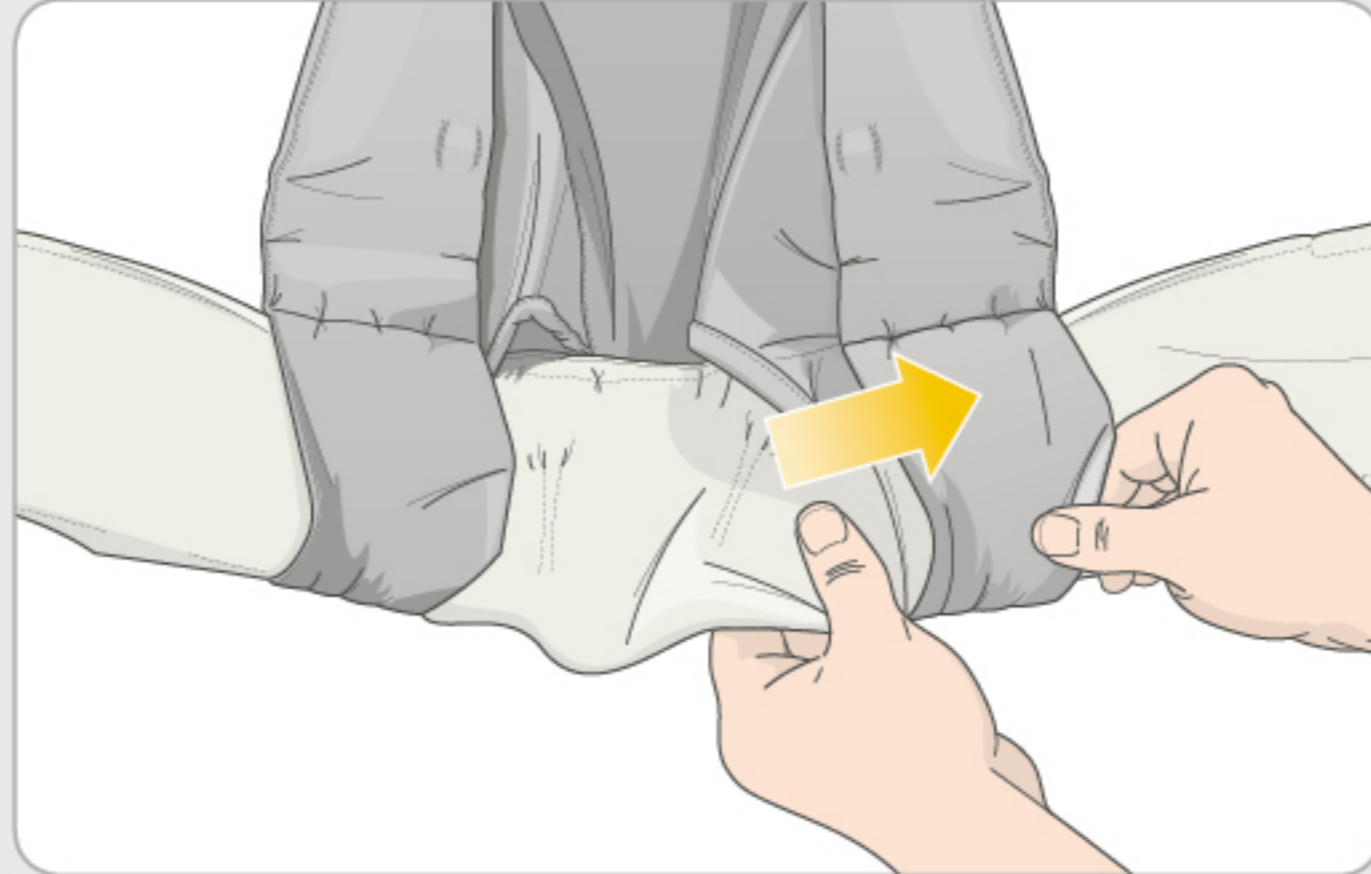
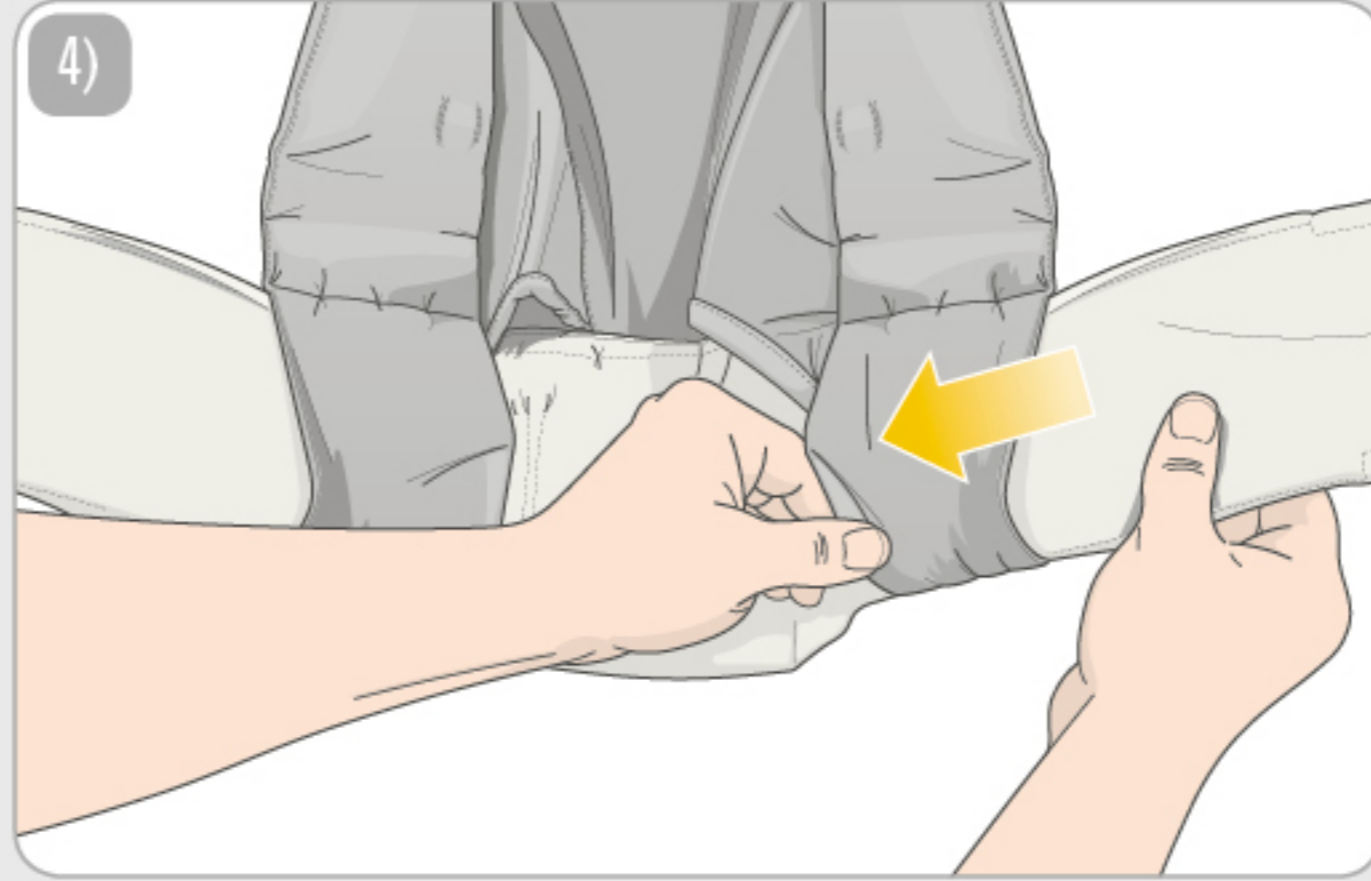

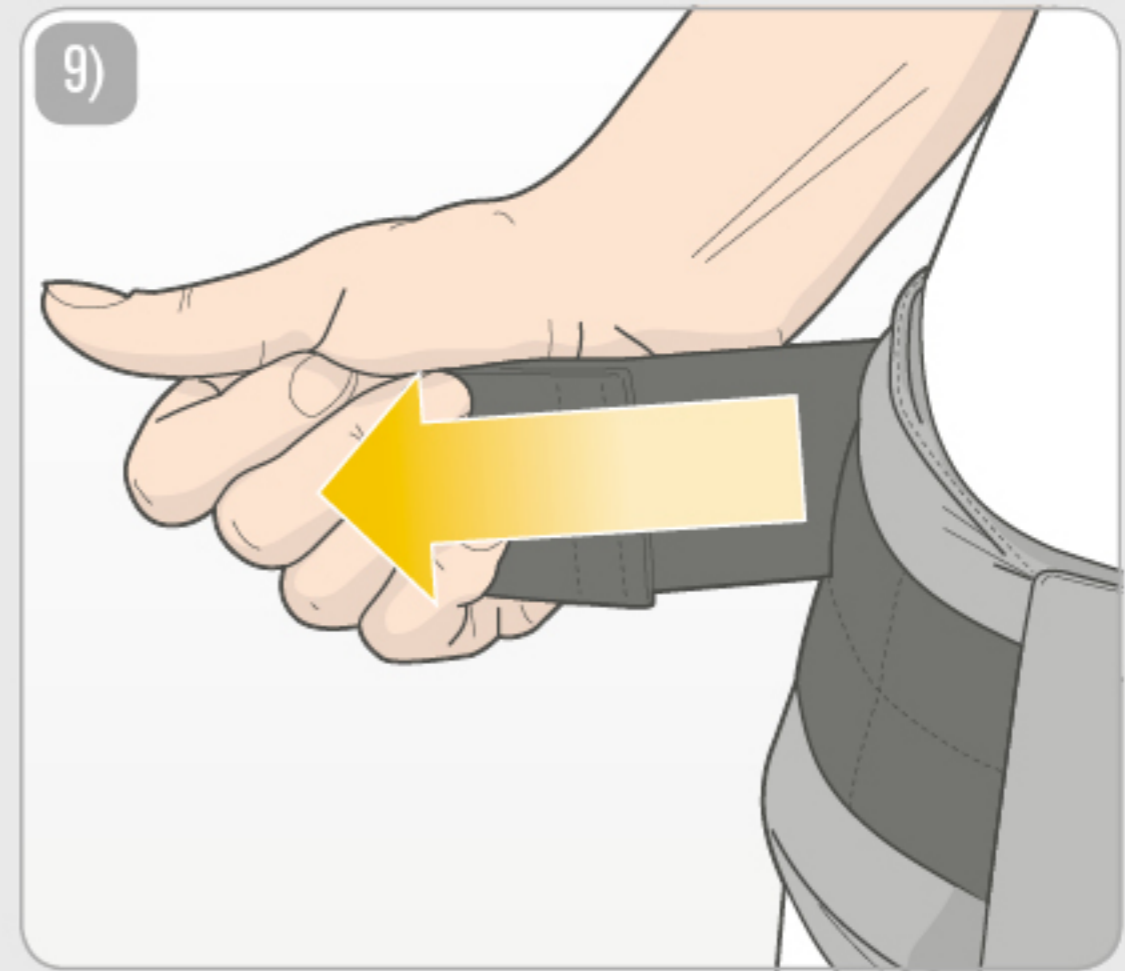
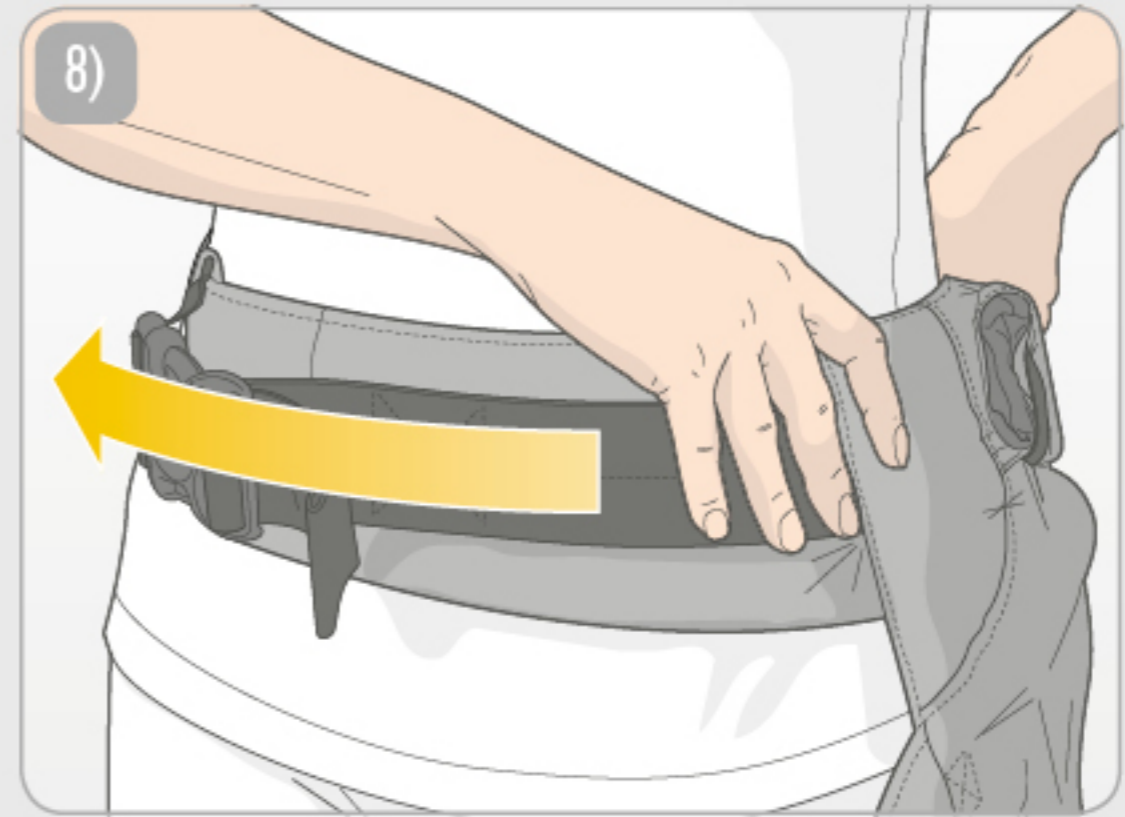
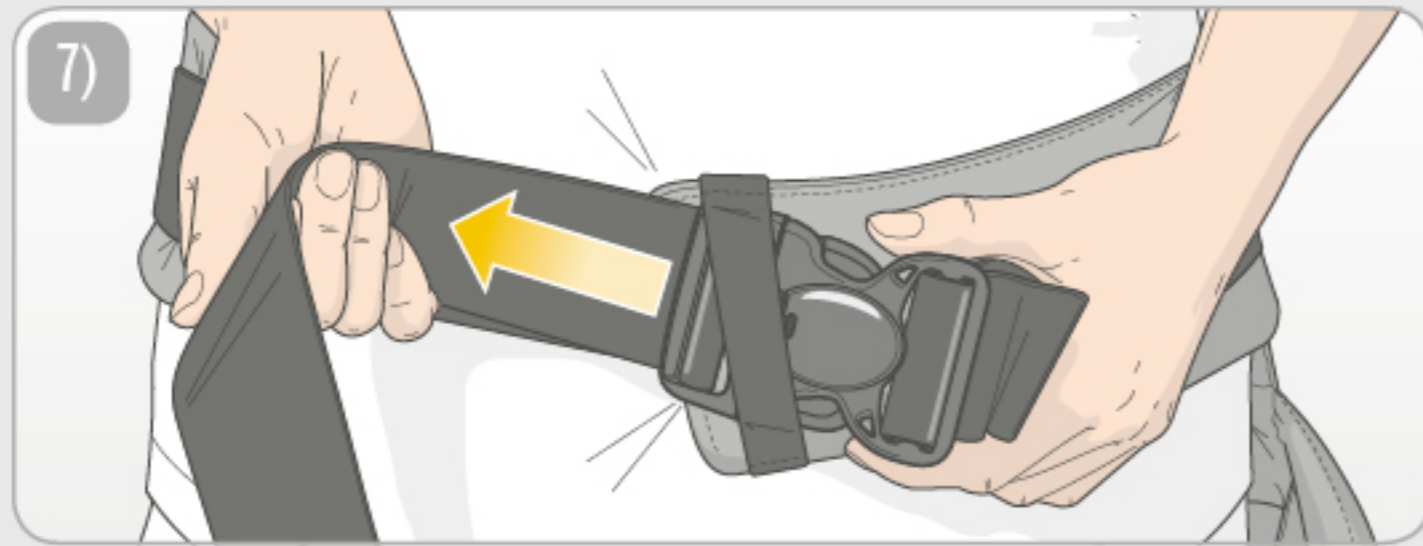
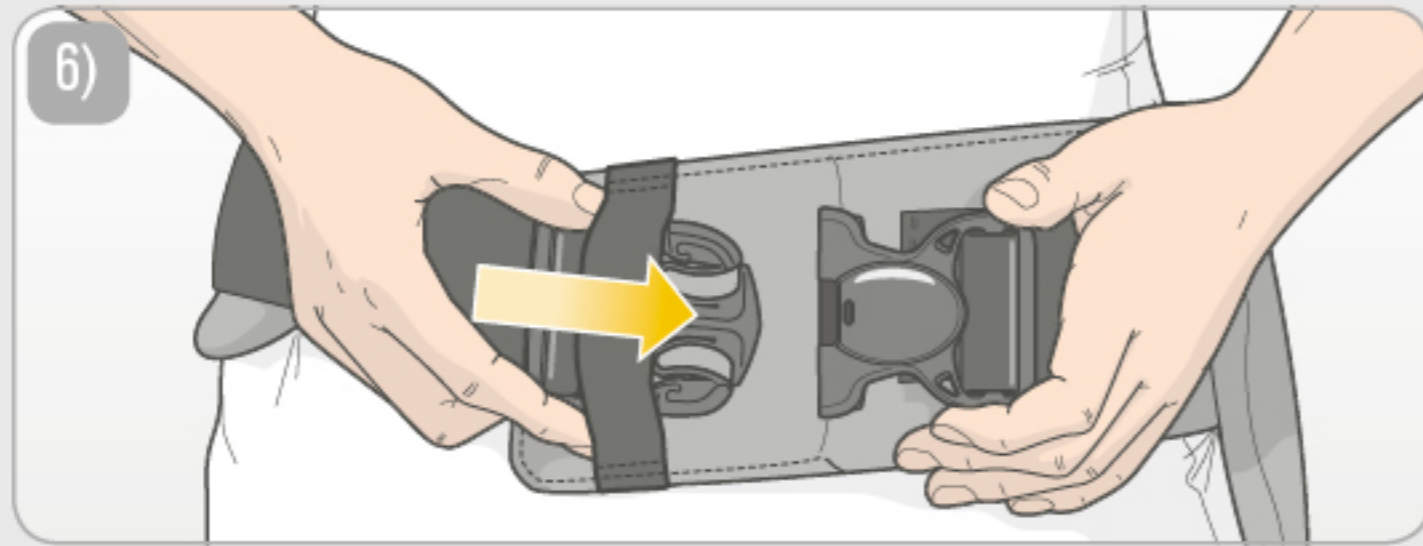
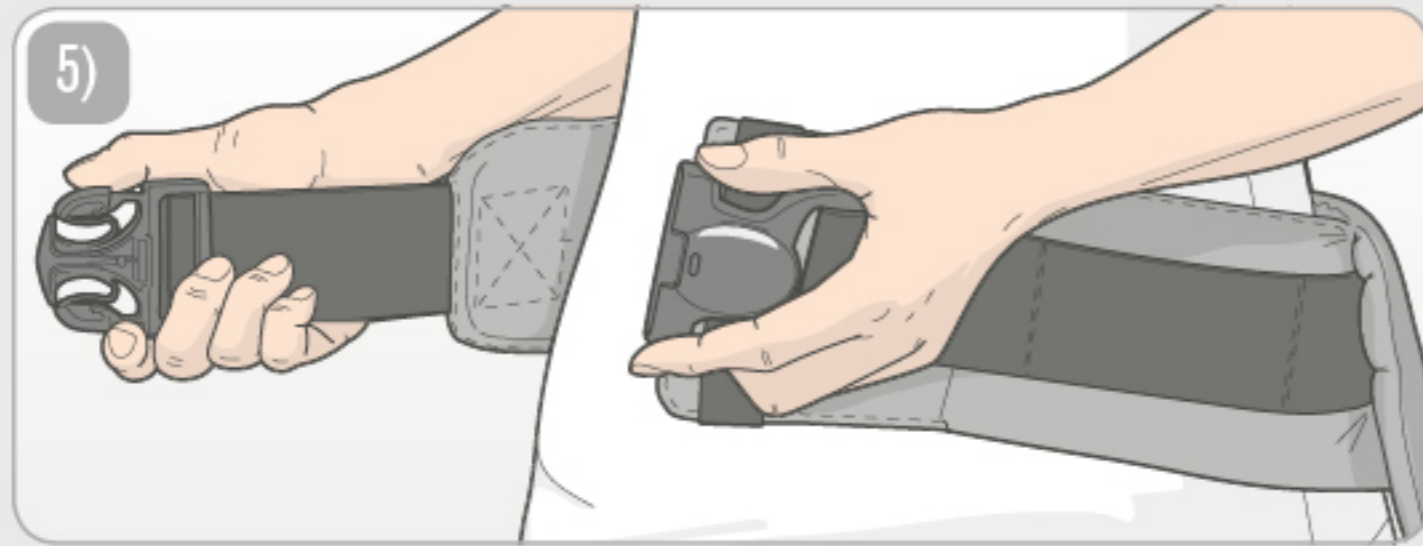

Bæring på magen

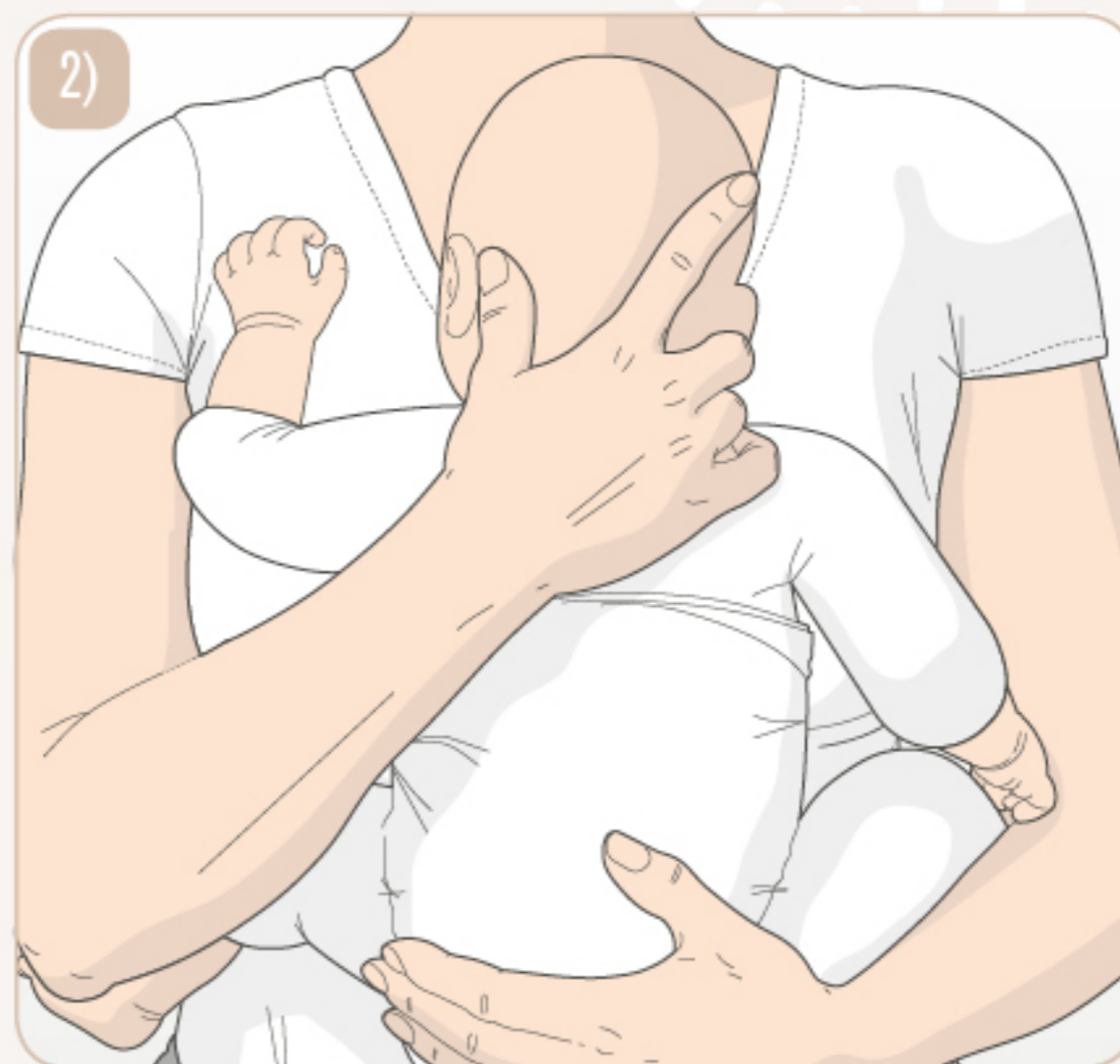



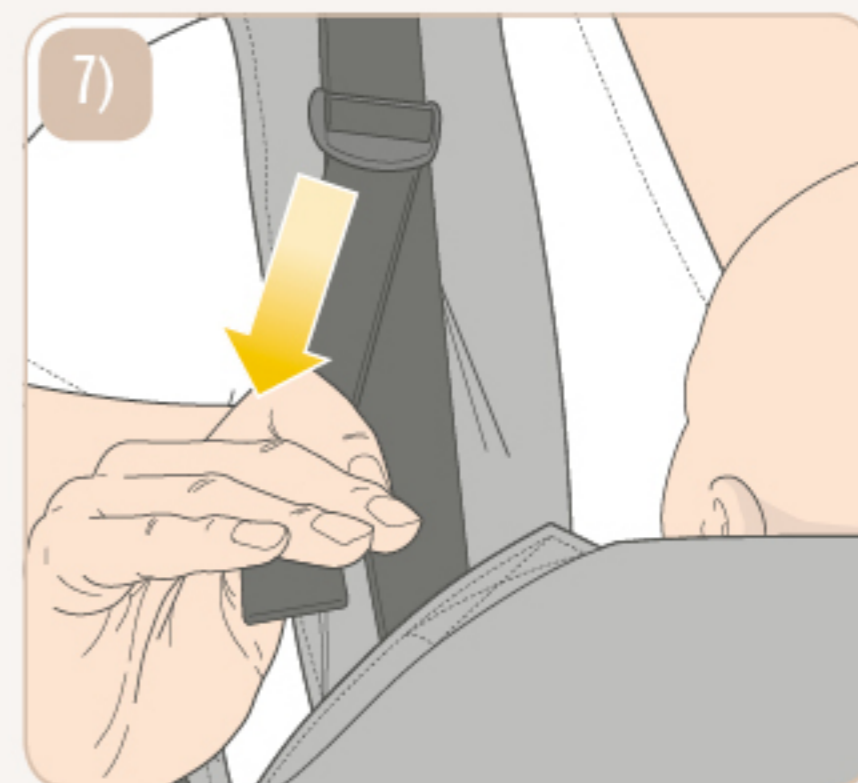
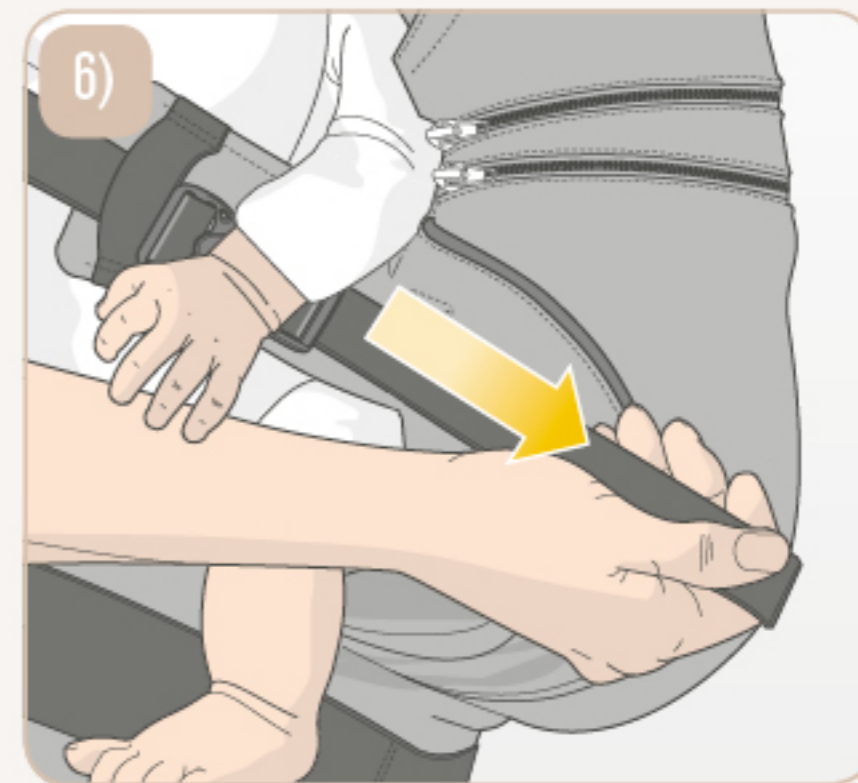
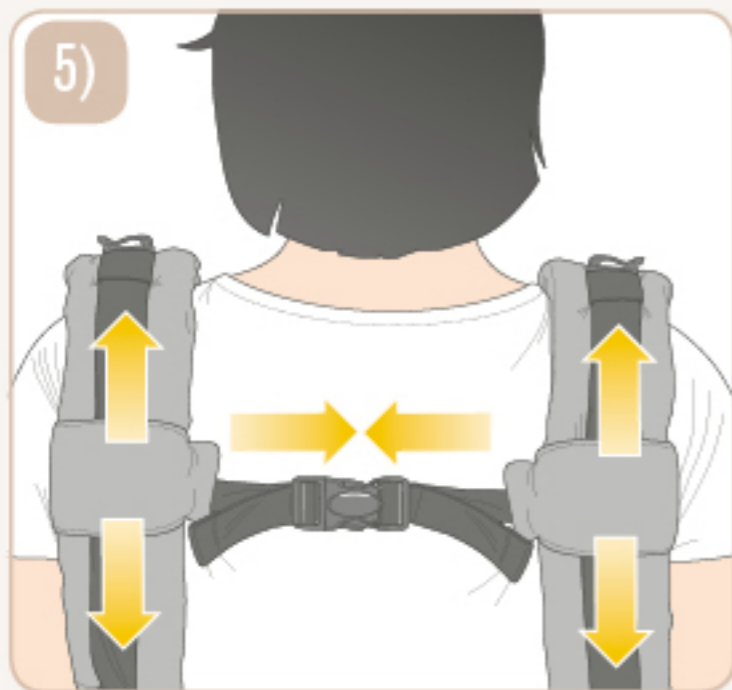

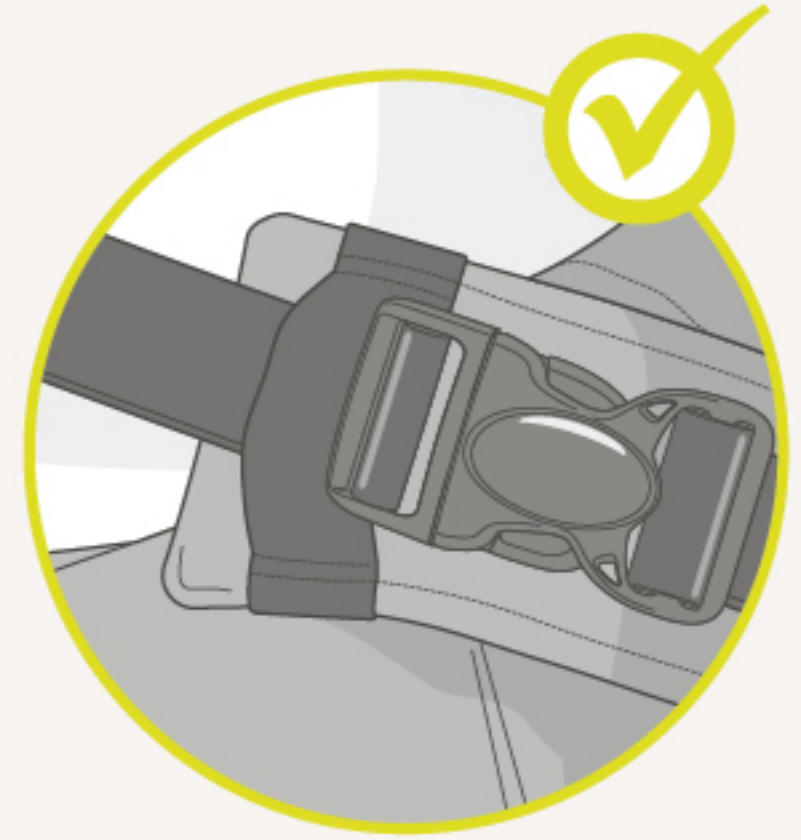
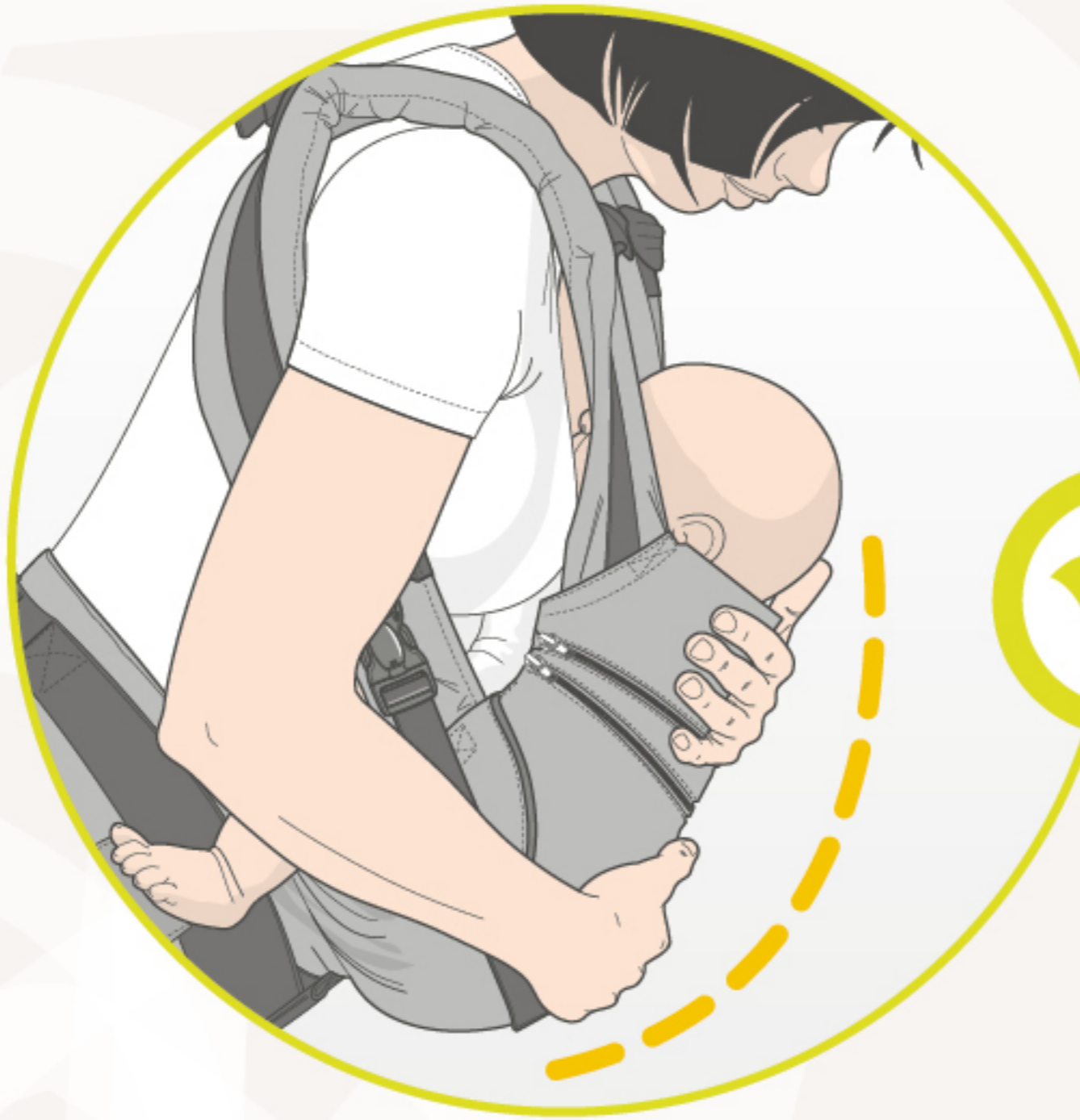

Bæring på magen



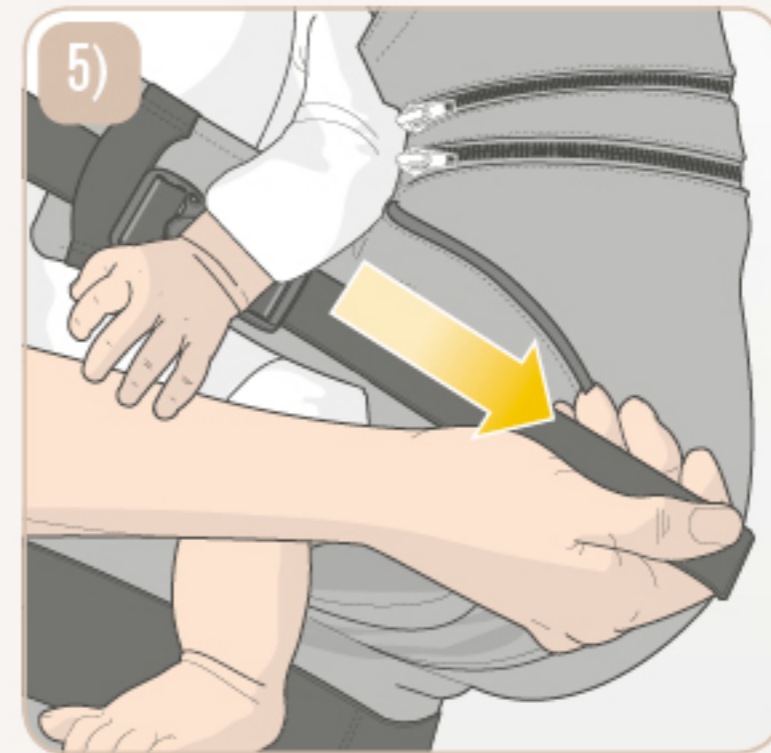
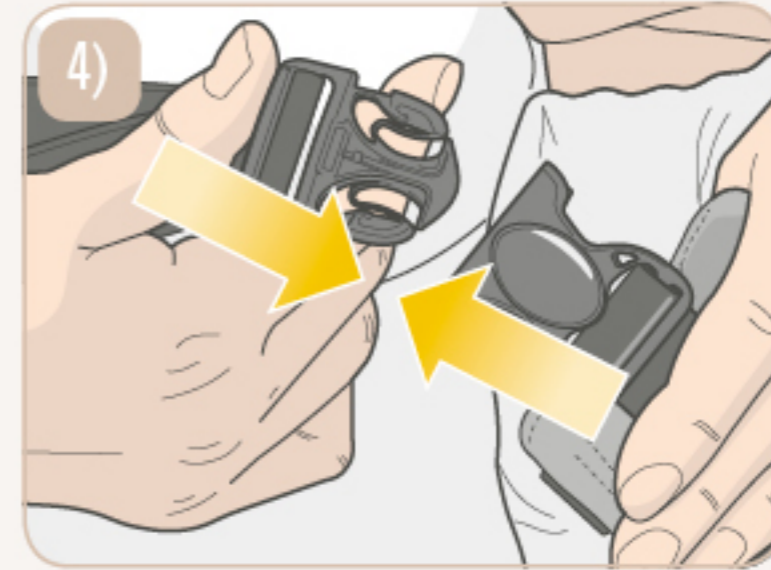
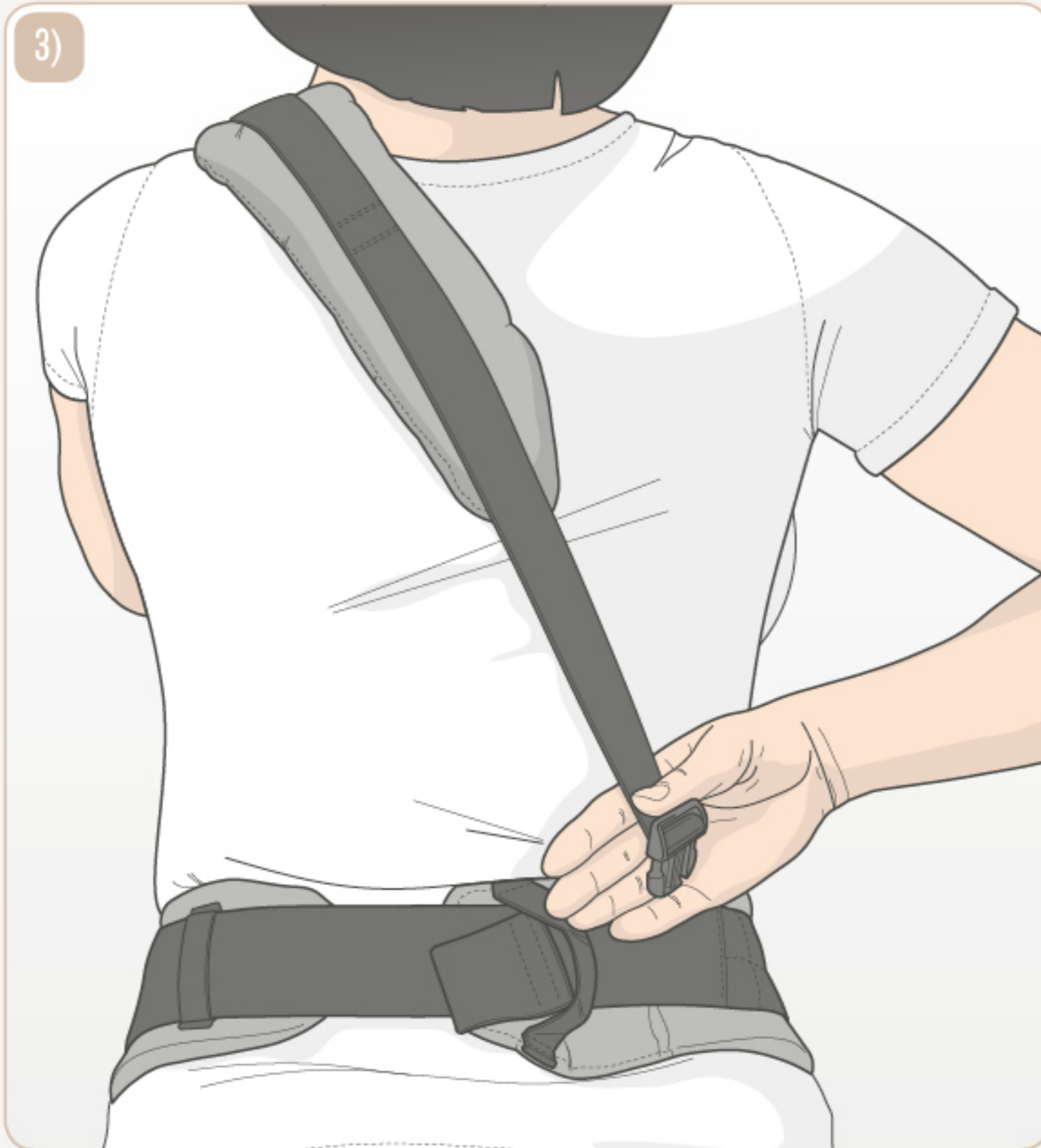

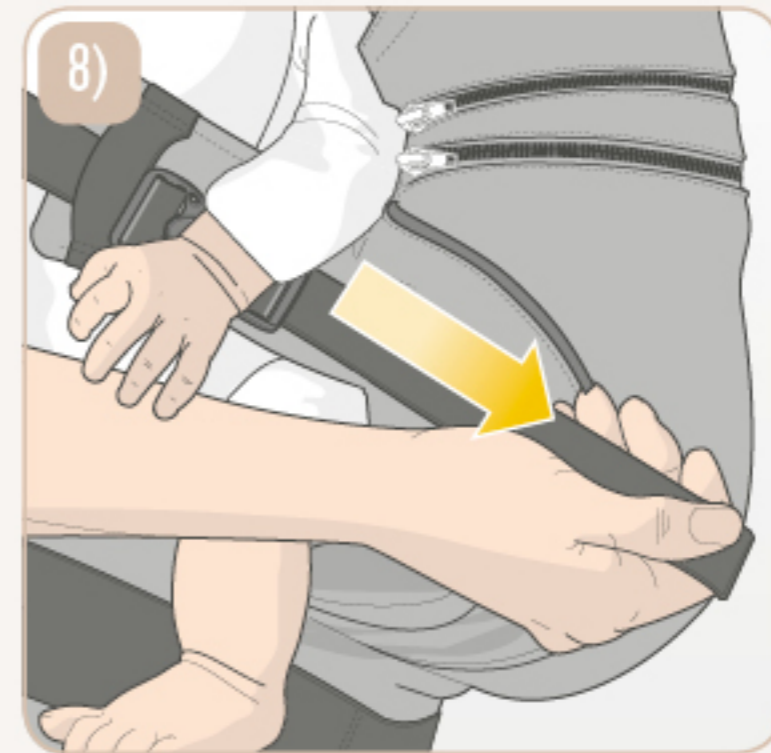
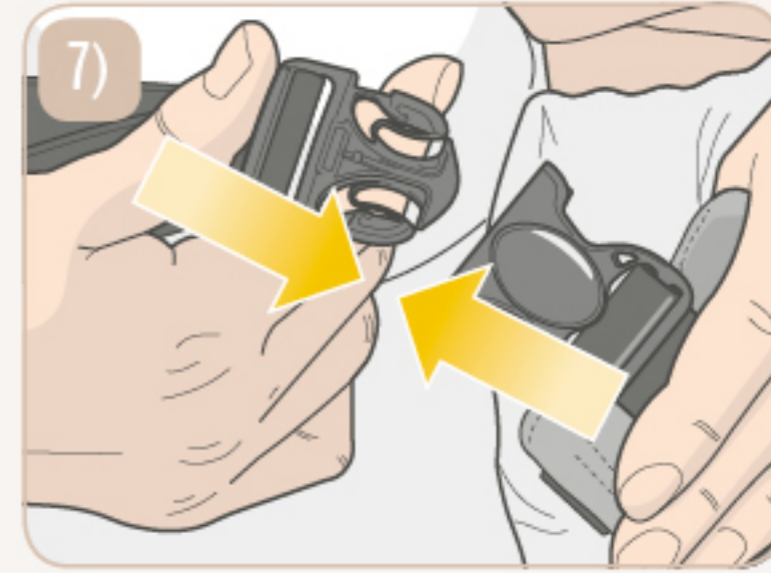
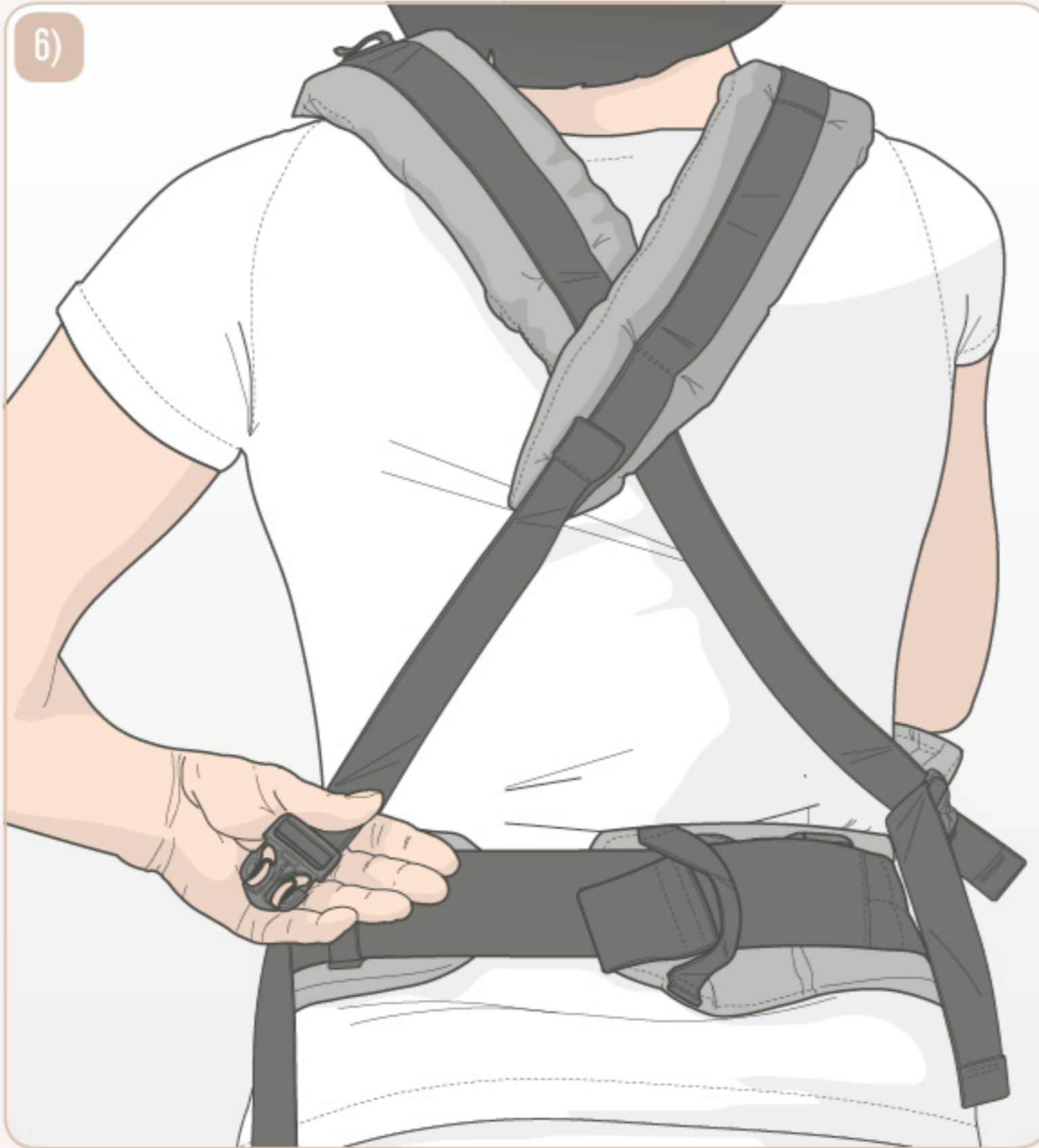

manduca®

my baby carrier /
mon porte-bébé

xt

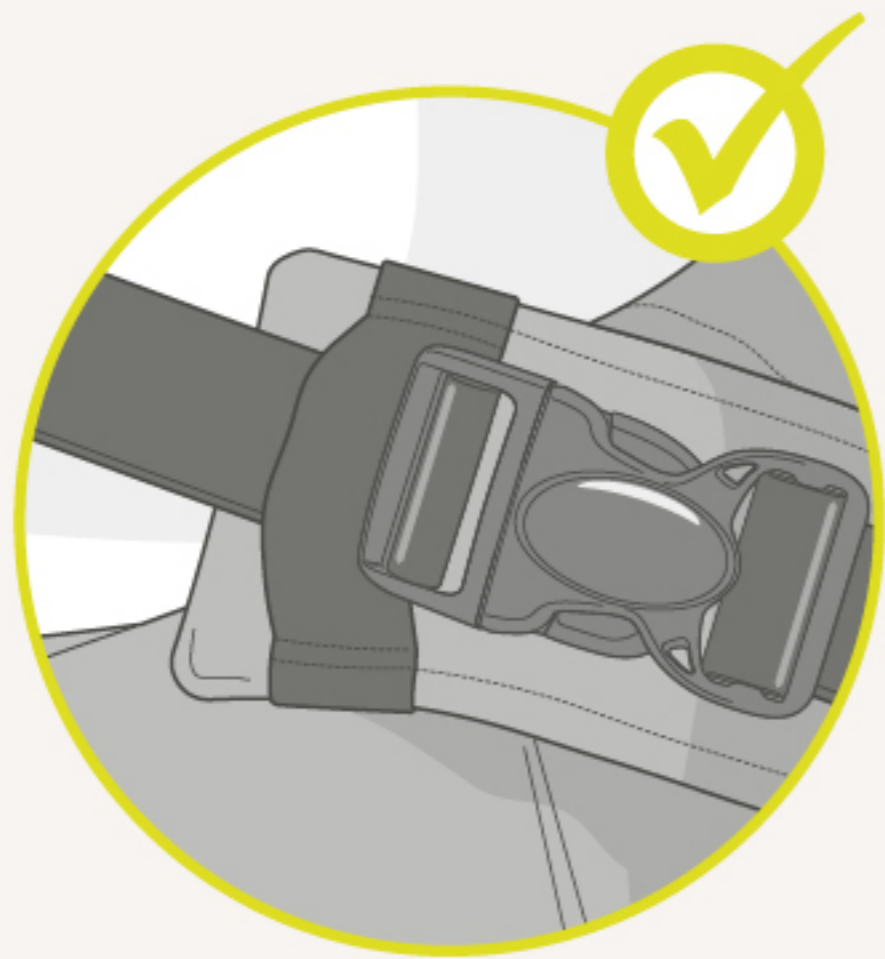



>3 mo.

Bæring på hoften

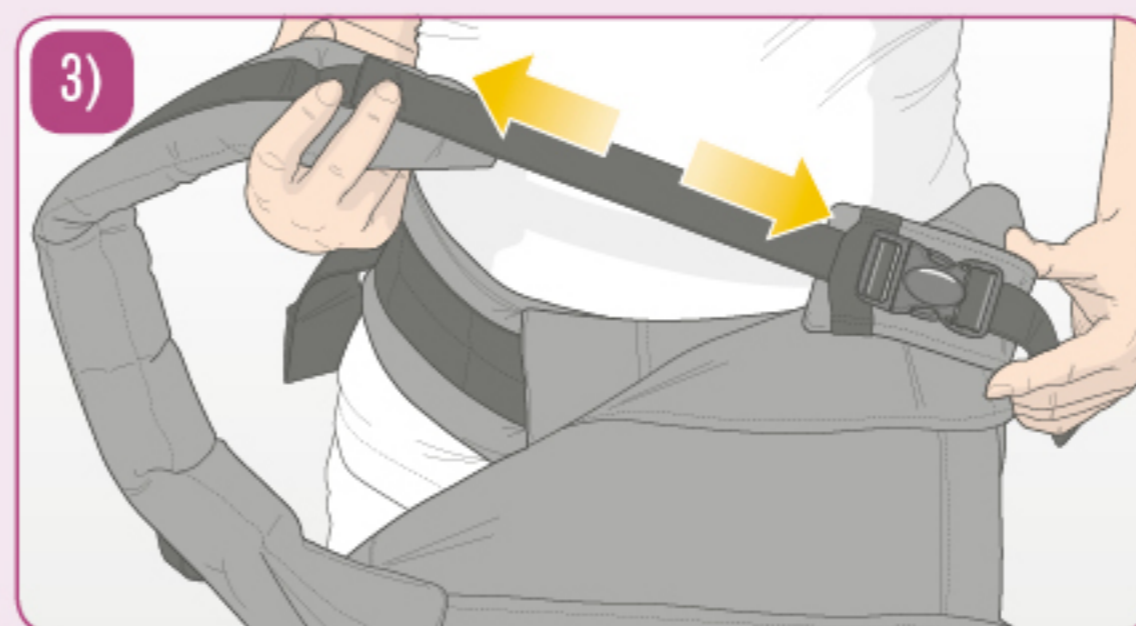
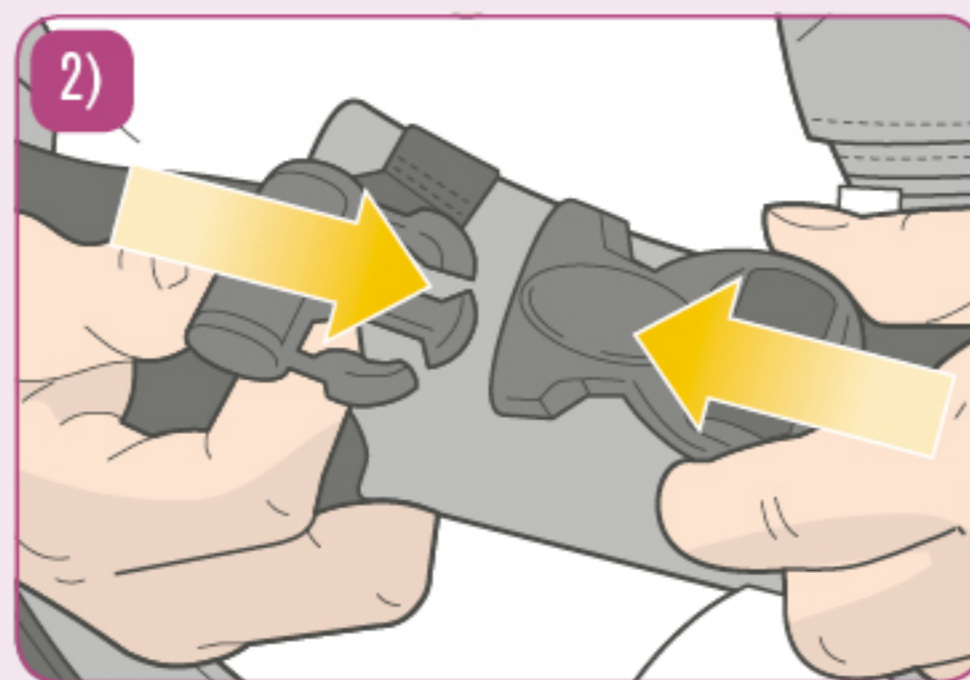
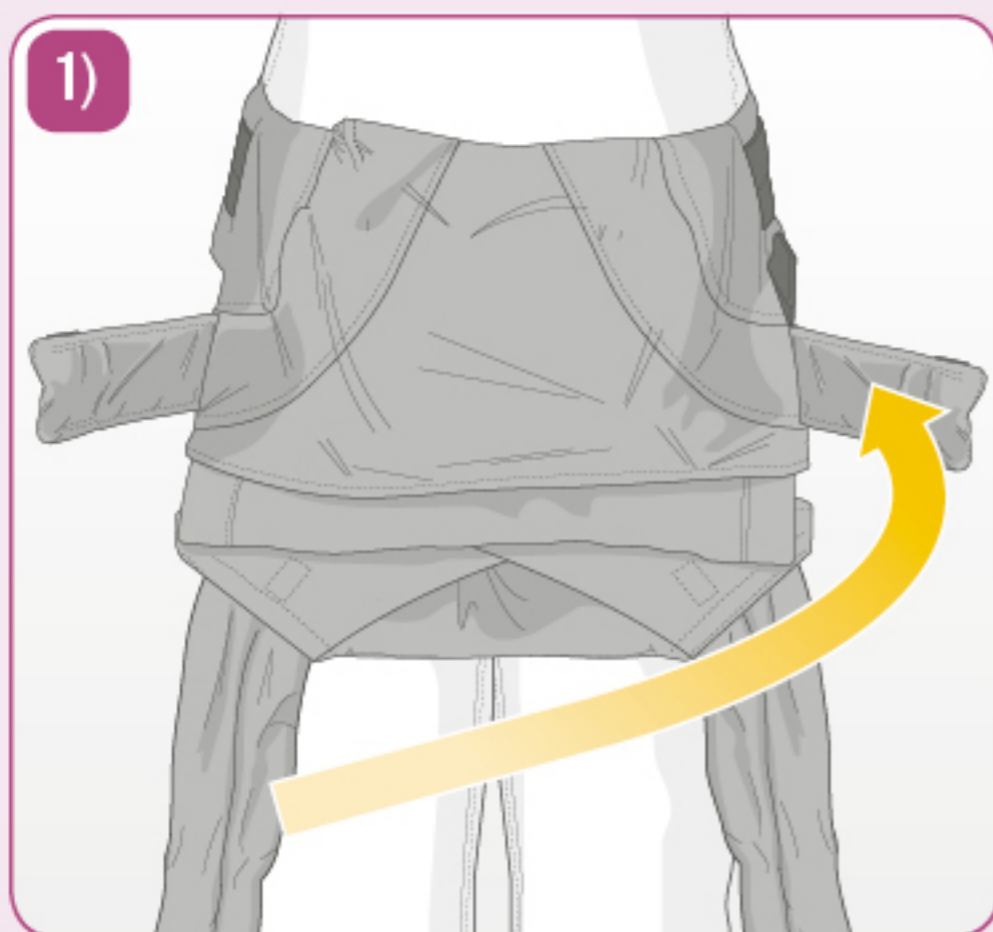

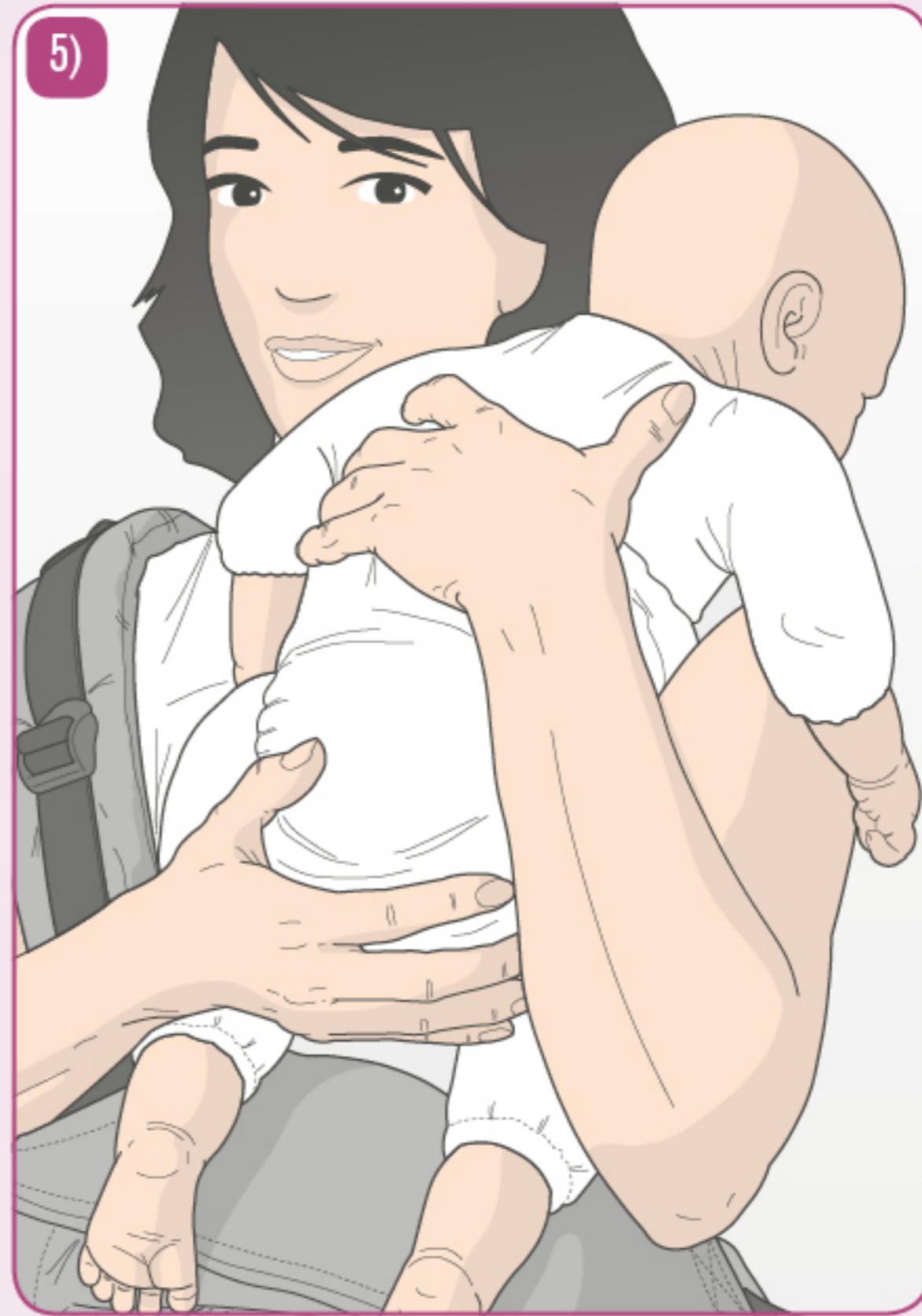

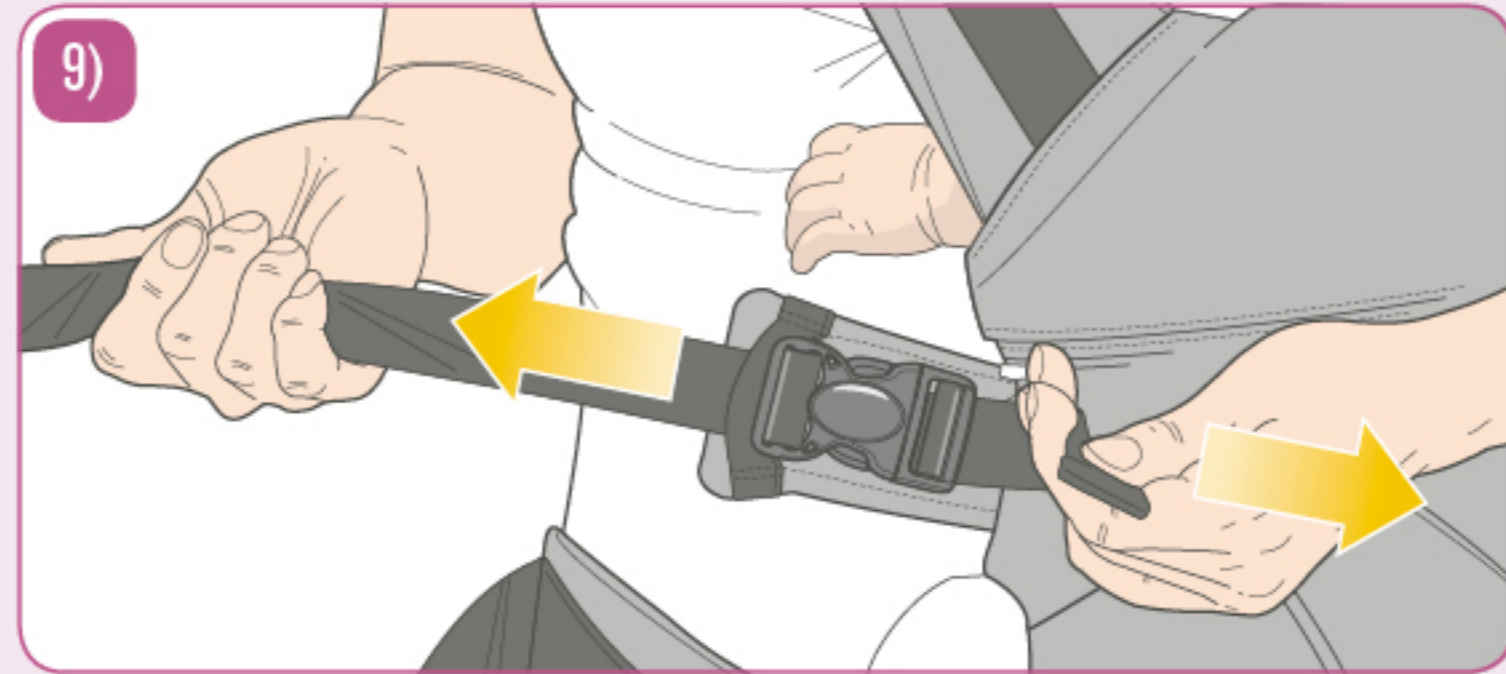
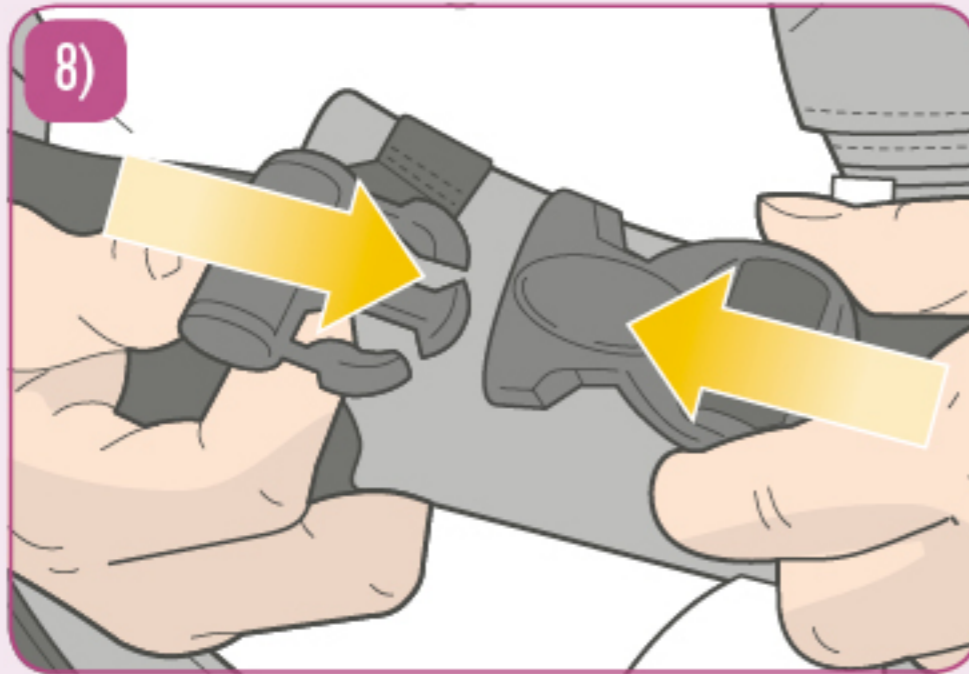
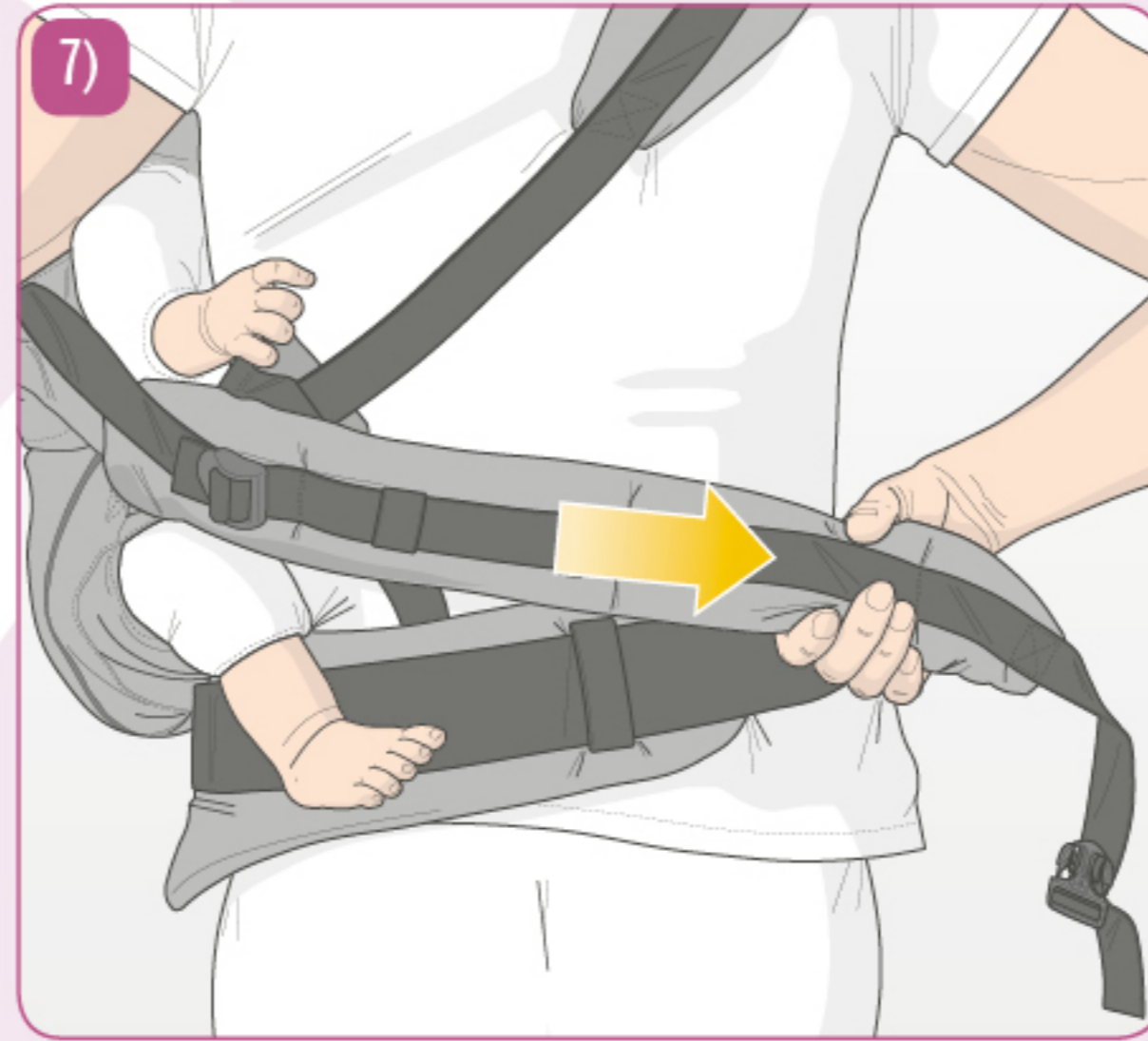

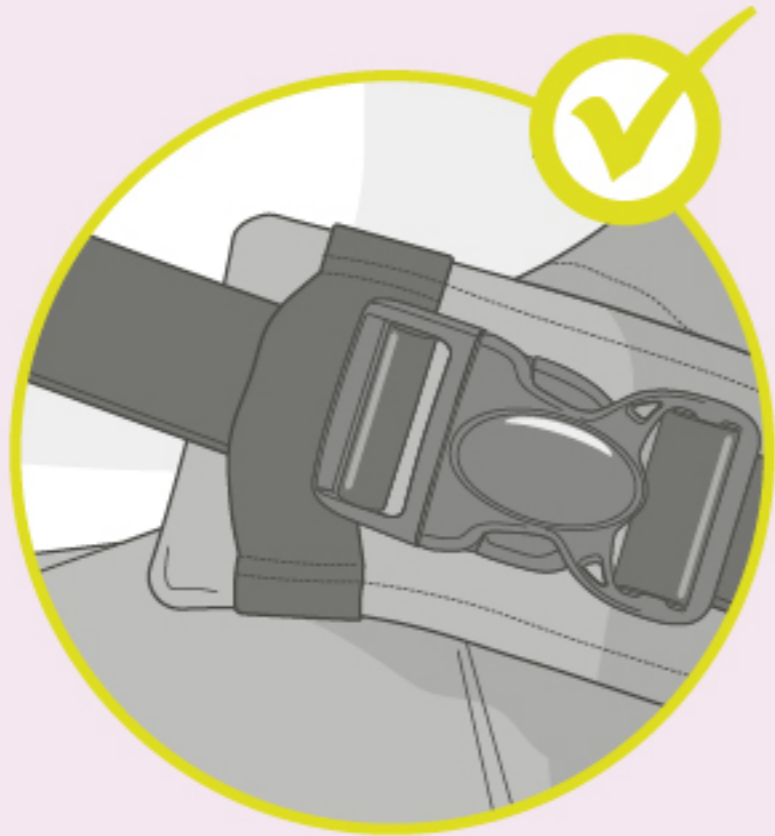



>3 mo.

Ryggbæring



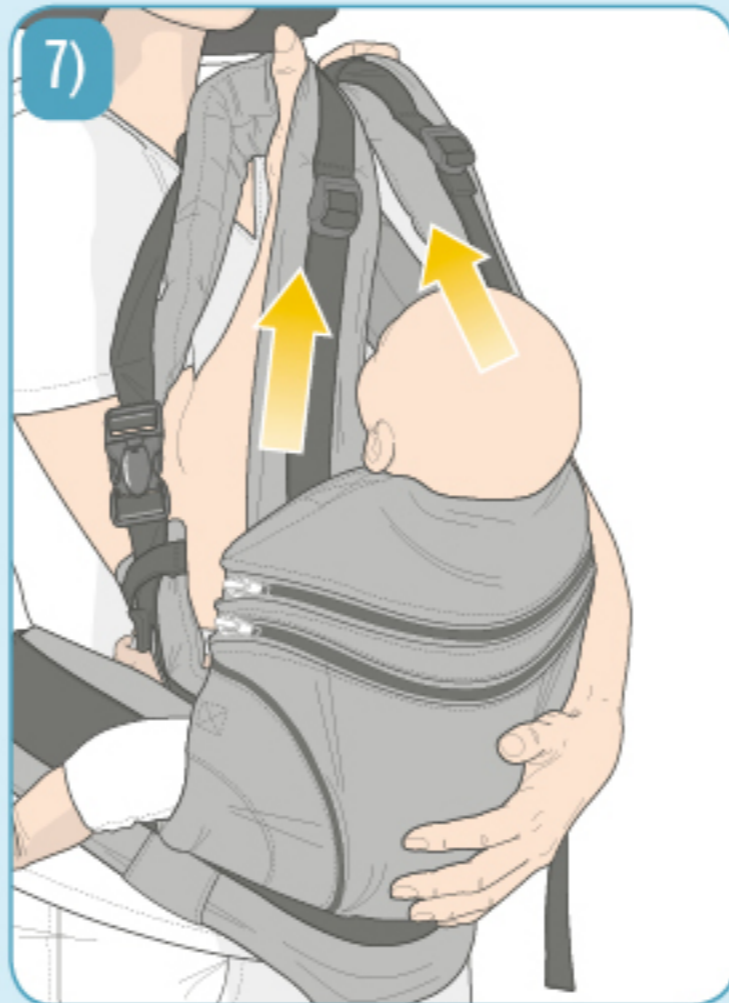

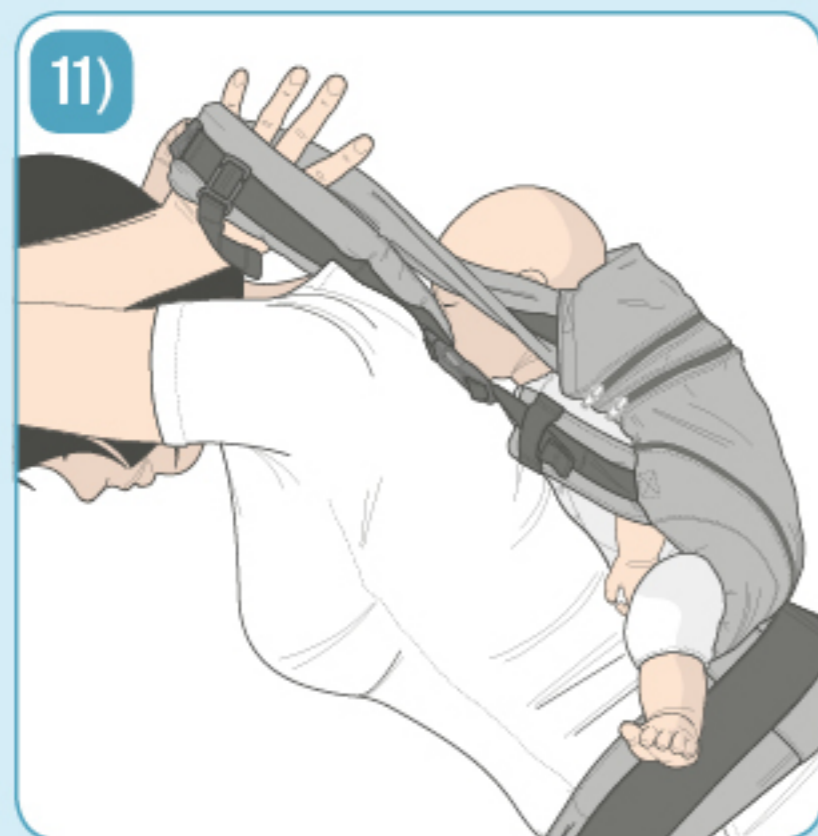

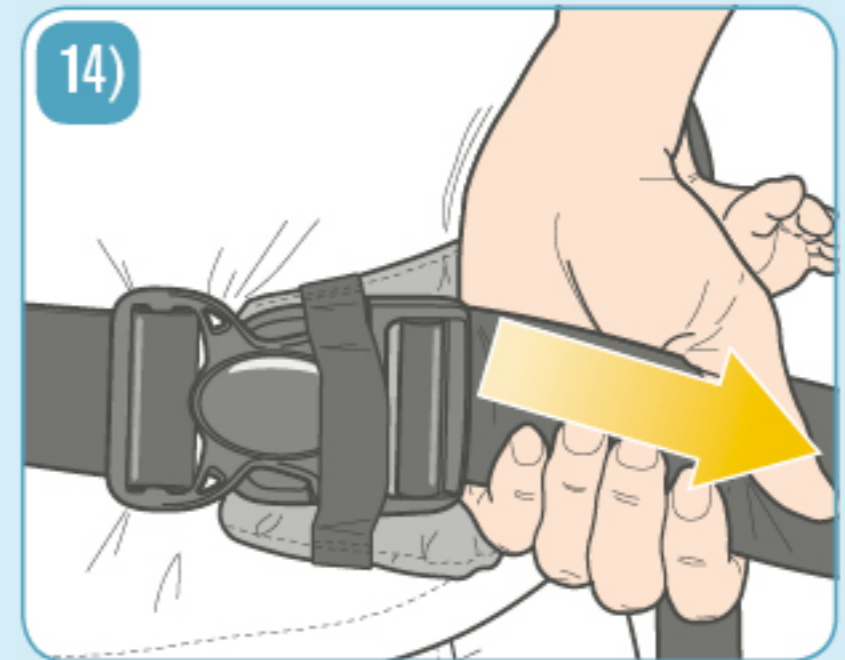
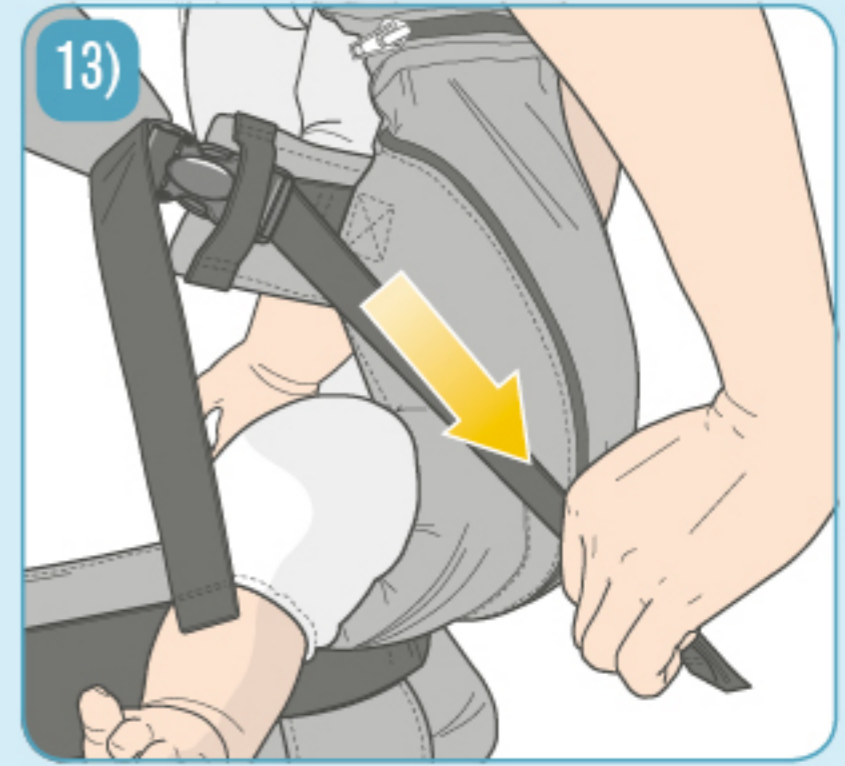
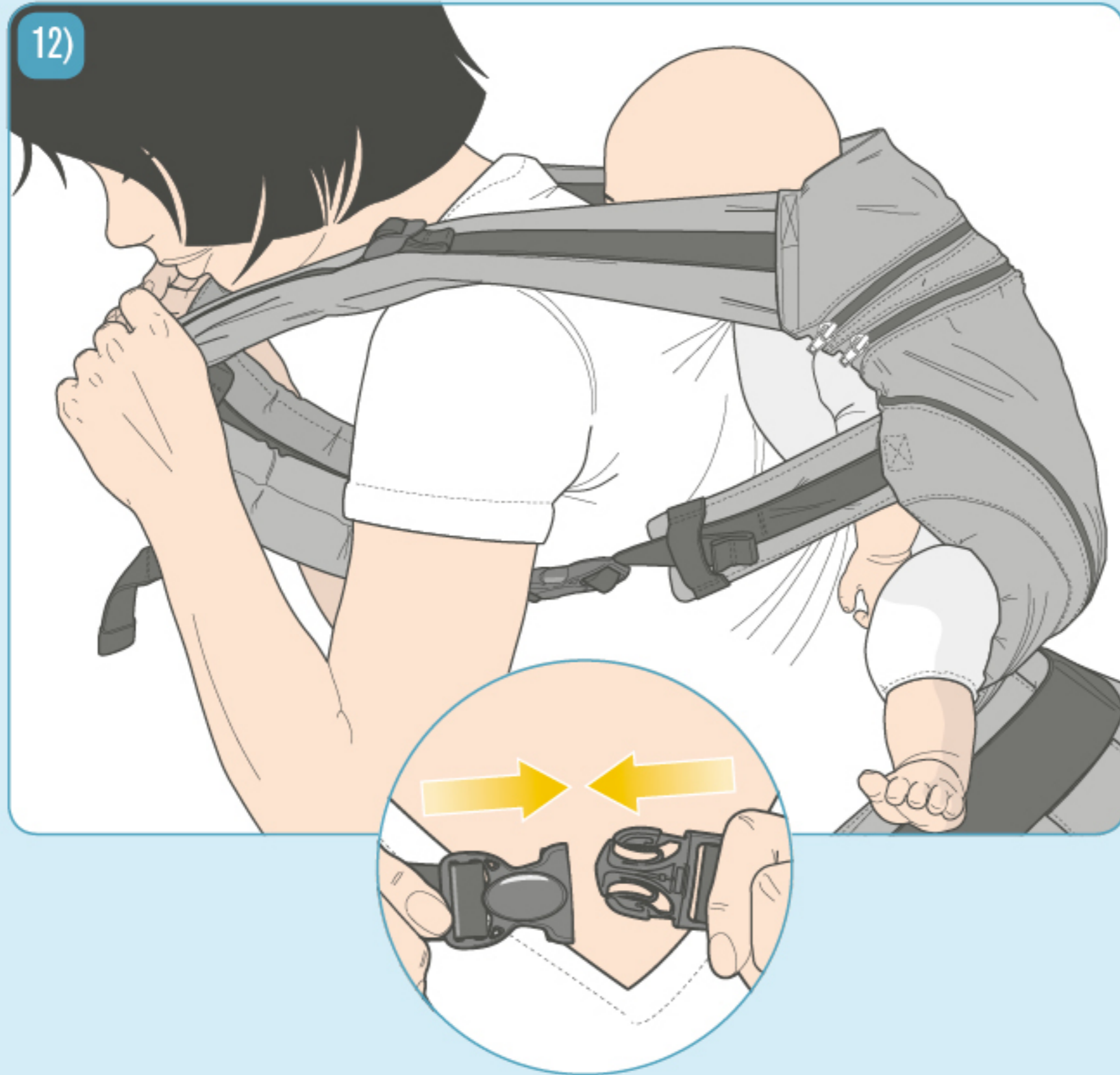



>9 mo.

Ryggbæring



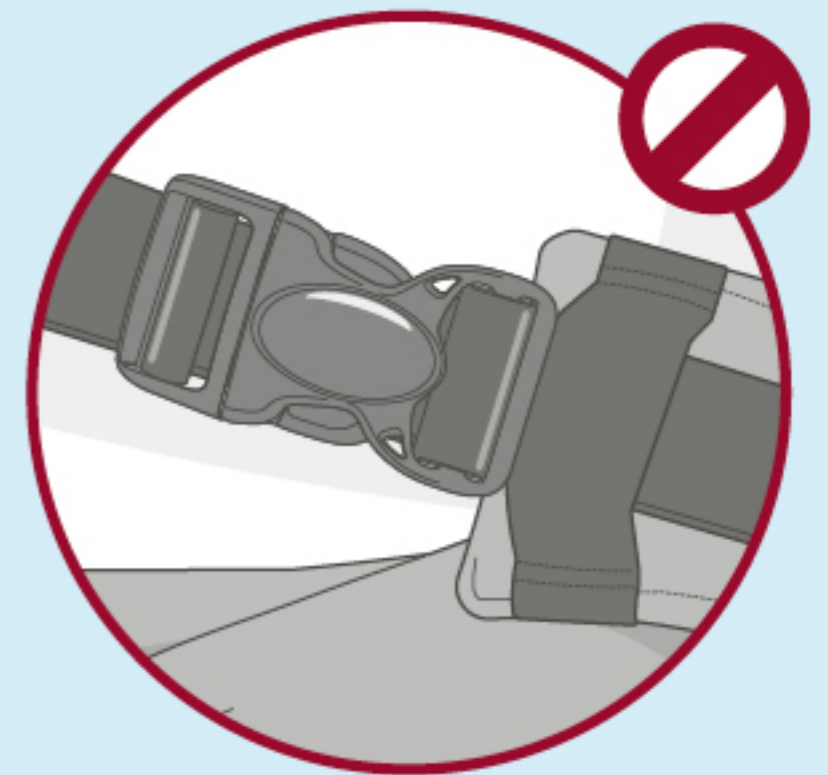
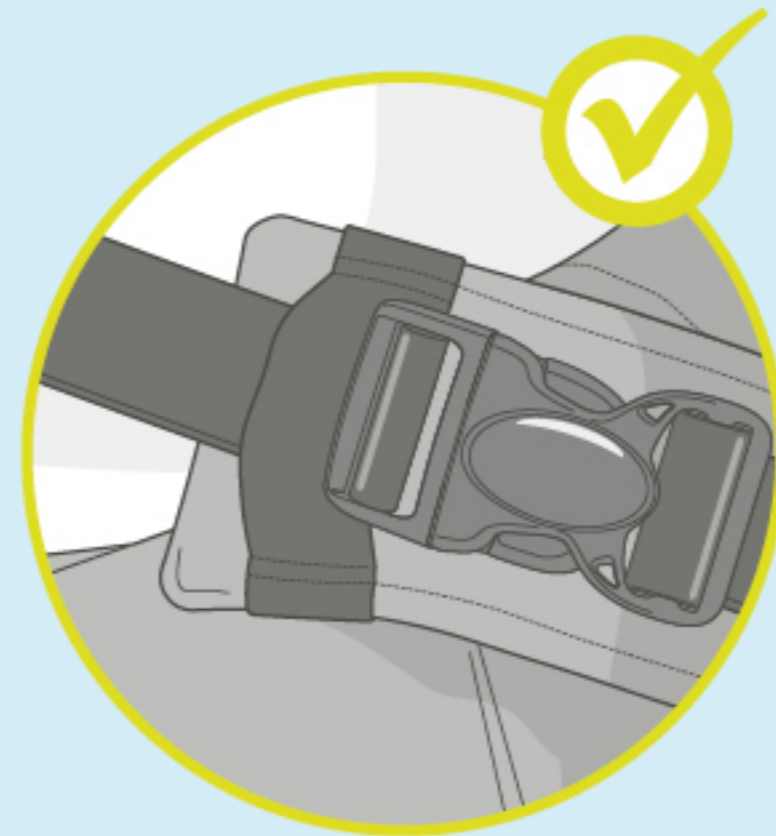
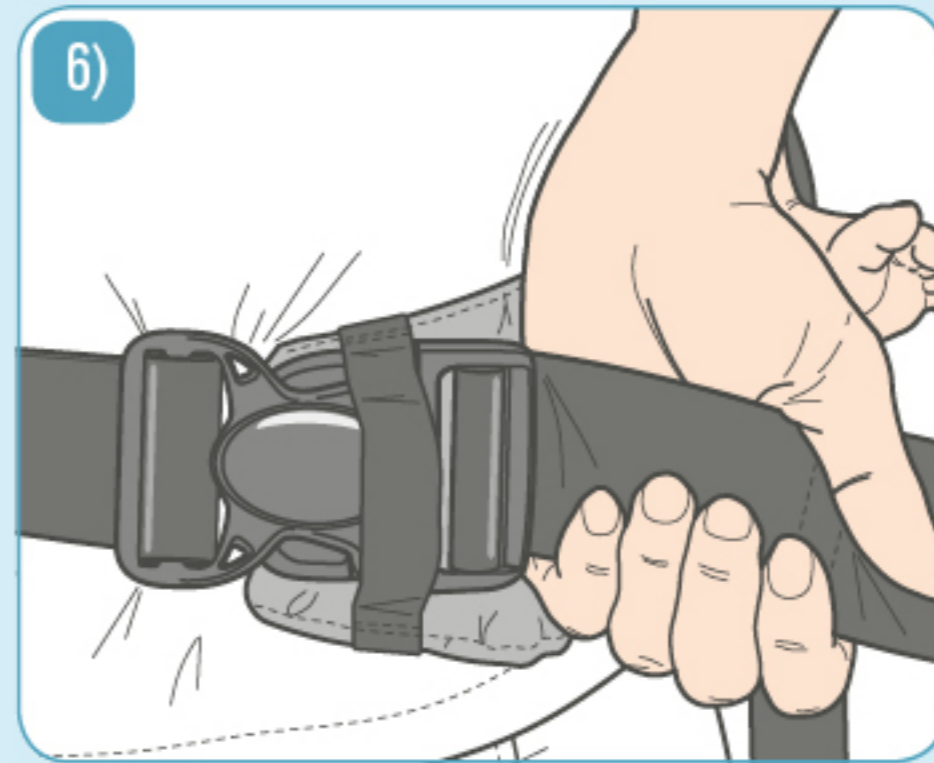
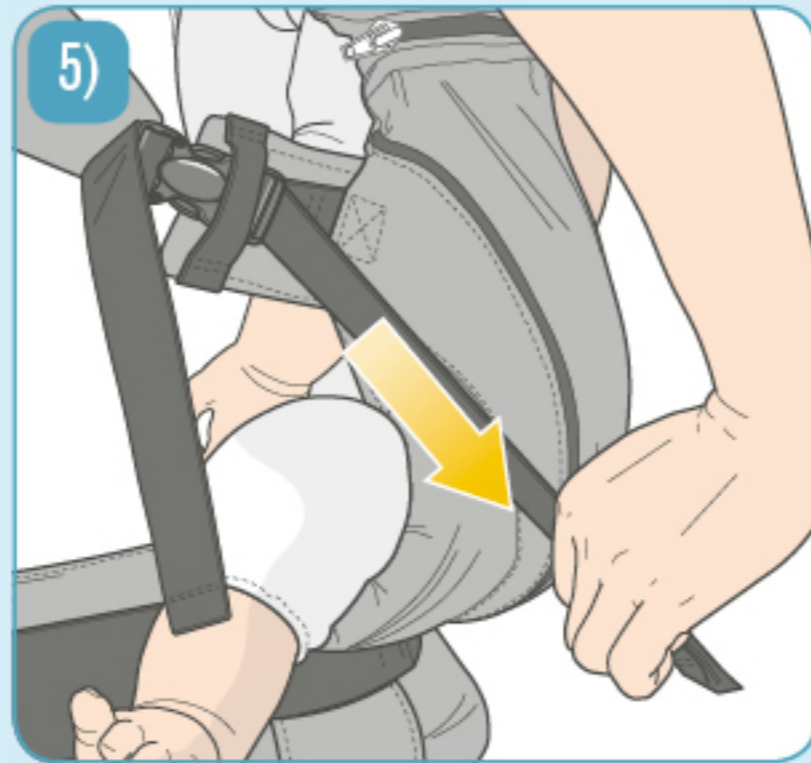

min/max
3,5/20 kg
7.7/44 lbs

manduca®

Kontakt / Contact :
GWS GmbH
Blochmattenstraße 16
79423 Heitersheim
Germany
Tel. +49 (0)7634 50762-01
info@manduca.de

